



Packington Street, N1

£450,000

This delightful new build was completed in 2012. Featuring open plan kitchen & living, this well presented one bed one bath property is on the second floor with a private east facing balcony.

A short walk leads to Angel Station or a plethora restaurants, bars and shops on Upper Street. A walk into the City is easy for commuters and Regent's Canal is on the doorstep for a run or Sunday stroll.

Features

- One Bedroom
- New Build
- Second Floor
- Private Balcony
- Lift Access
- Chain Free

Packington Street,
London, N1

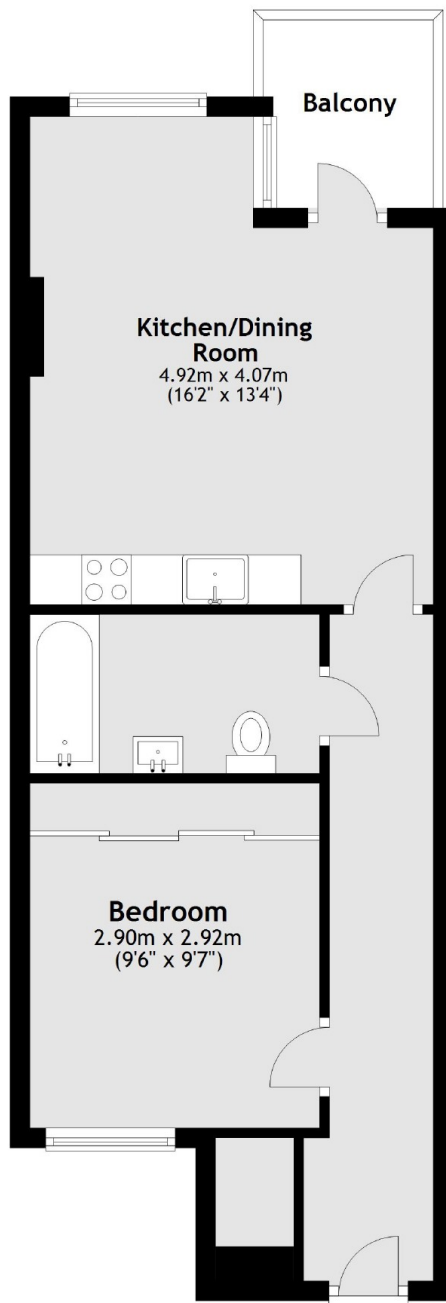

Main area: Approx. 42.8 sq. metres (461.1 sq. feet)
Plus balconies, approx. 3.4 sq. metres (36.9 sq. feet)