



Arundel Square, N7 £700,000

Formed in 1862 St. Clements Church was designed by Sir George Gilbert Scott and converted for residential use in the 1980's. Set over one level this stunning two bedroom double property is circa 975sqft and features amazing original stonework, separate kitchen and a large reception room set over the front of the property.

Highbury and Islington station is 0.3 miles away providing access to the Victoria line, London Overground and several bus routes into the heart of the city. Additionally, Islington's famous Upper Street with its plethora of trendy bars, cafés and restaurants is within easy reach.

Features

- Church Conversion
- Original Stone Work
- Separate Kitchen
- Two Double Bedrooms
- 975sqft

Arundel Square, London, N7

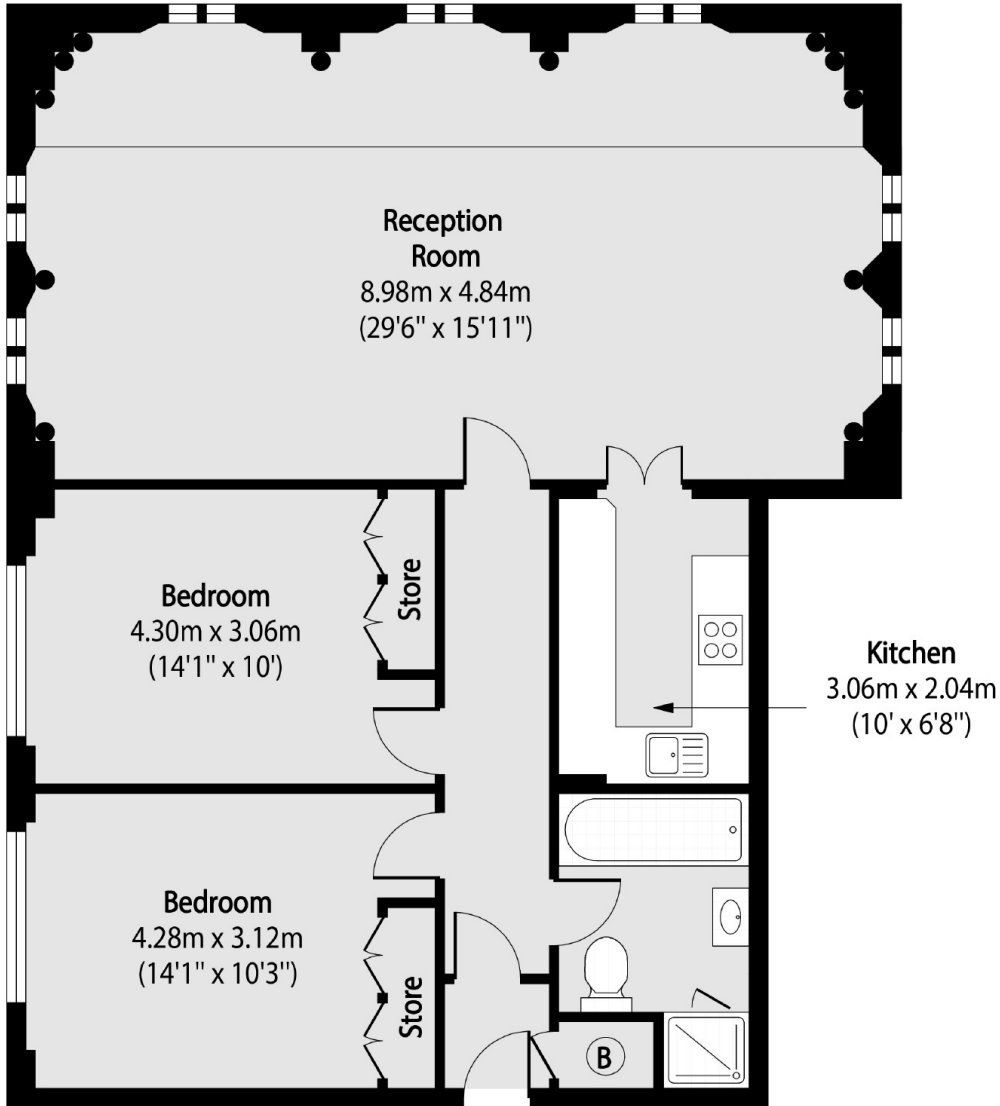

Total area (approx): 90.55 sq m (975 sq. ft)