



Mildmay Avenue, N1

£425,000

Mildmay Avenue is a quiet cul-de-sac in Islington, just south of Newington Green. The modern one bedroom home is set on the first floor and benefits from open plan kitchen/living room and a private balcony.

Located within easy reach of Canonbury, Highbury & Islington and Dalston stations and is ideally located for for the shops bars and restaurants along Islington's Upper Street.

Features

- One Bedroom
- First Floor
- Private Balcony
- Modern Development
- Open Plan

Mildmay Avenue, London, N1

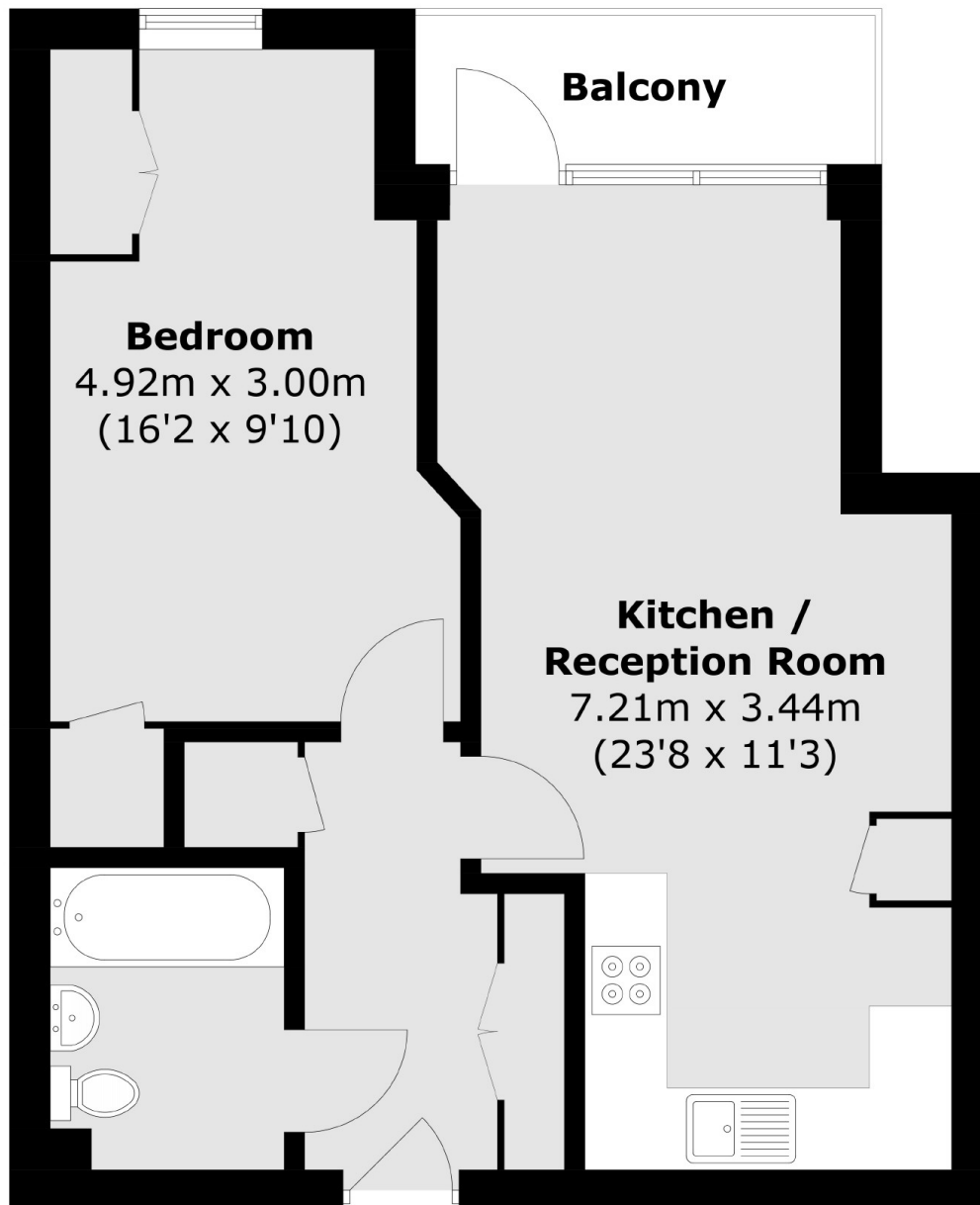

Total area (approx.): 47.9 sq. m (515.6 sq. ft)
Balcony: 3.7 sq. m (39.8 sq. ft)