



Cloudesley Road, N1 £600,000

Situated in the ever popular Barnsbury area on arguably one of the finest residential streets is this beautiful one bedroom garden flat. This chain free apartment has Share of Freehold, private entrance and an open plan living/ kitchen leading to the private sunny garden.

Cloudesley Road is a highly sought after road in the heart of Barnsbury. Located close to Upper Streets plethora of bars, shops and restaurants with both Angel and Highbury & Islington tube stations within easy walking distance.

Features

- OIEO £600,000
- Share of Freehold
- Chain Free
- Private Entrance
- Private Garden
- Period Conversion
- One Bedroom

Cloudesley Road, London, N1

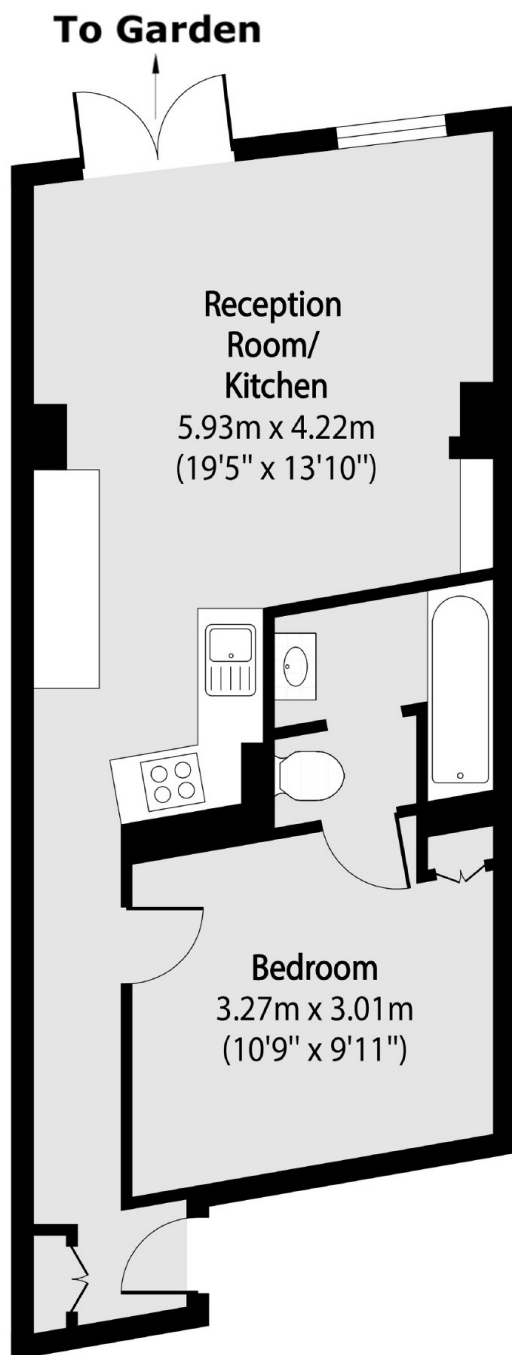

Total area (approx): 40.56 sq m (437 sq. ft)