



## River Street, EC1R

£550,000

Ideally located just off of Myddelton Square, this bright, top floor one bedroom apartment is generously sized with high ceilings, a separate kitchen and is offered chain free.

River Street is remarkable for its transport connections. St Pancras International has the Eurostar link to continental Europe, and, with King's Cross, has main line connections to the north. The redeveloped Farringdon Station has the new Elizabeth Line with fast link to Heathrow airport and Thames Link to Gatwick and Luton.

### Features

- Top Floor
- Period Conversion
- Chain Free
- South Facing Reception
- Centrally Located

# River Street, London, EC1R

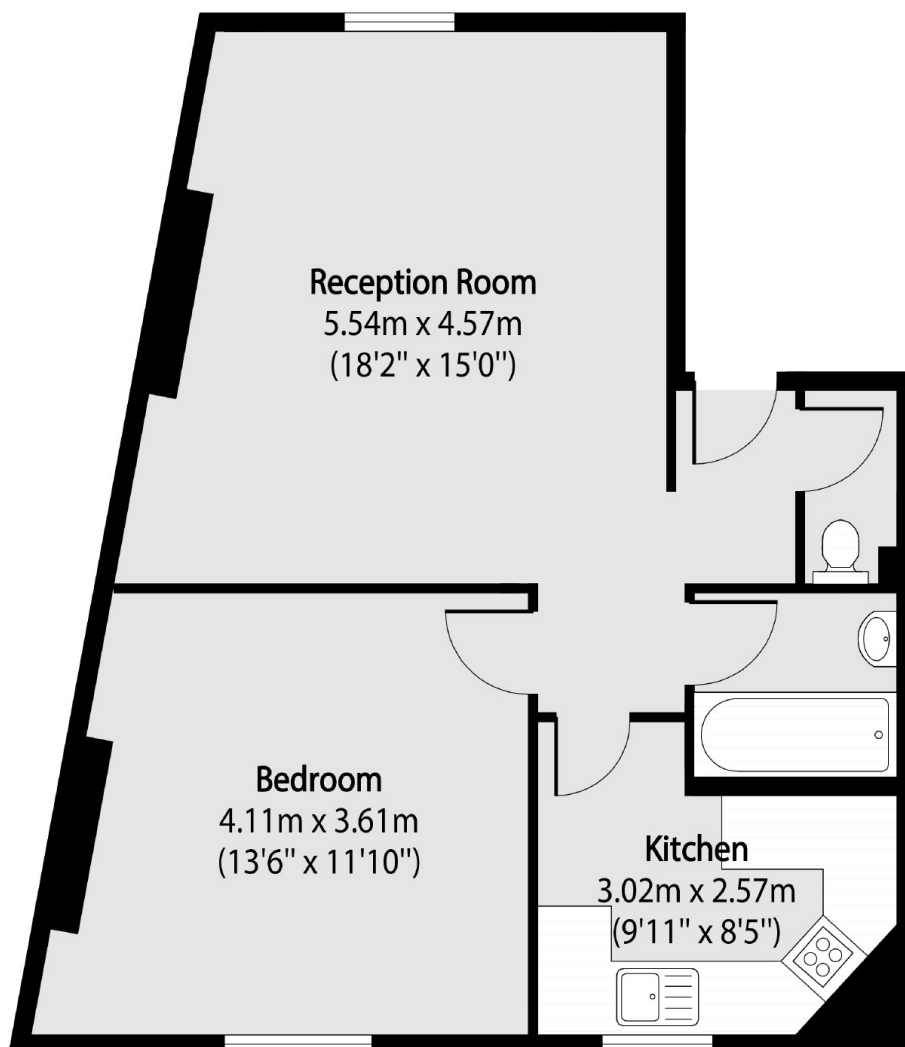

Total area (approx): 47.10 sq m (507 sq. ft)