



## Mildmay Road, N1

£400,000

This beautifully presented one bedroom period flat is just moments from the highly sought after area of Newington Green. Situated on the top floor this flat benefits from an abundance of natural light, wooden floors and a modern feel throughout.

This property is ideally located close to Newington Green with boutique delis, popular shops and cafés. The nearest station is Canonbury Overground and there are numerous bus links to the City close by.

### Features

- One Bedroom
- Victorian Conversion
- Top Floor
- Chain Free
- 114 Year Lease

# Mildmay Road, London, N1

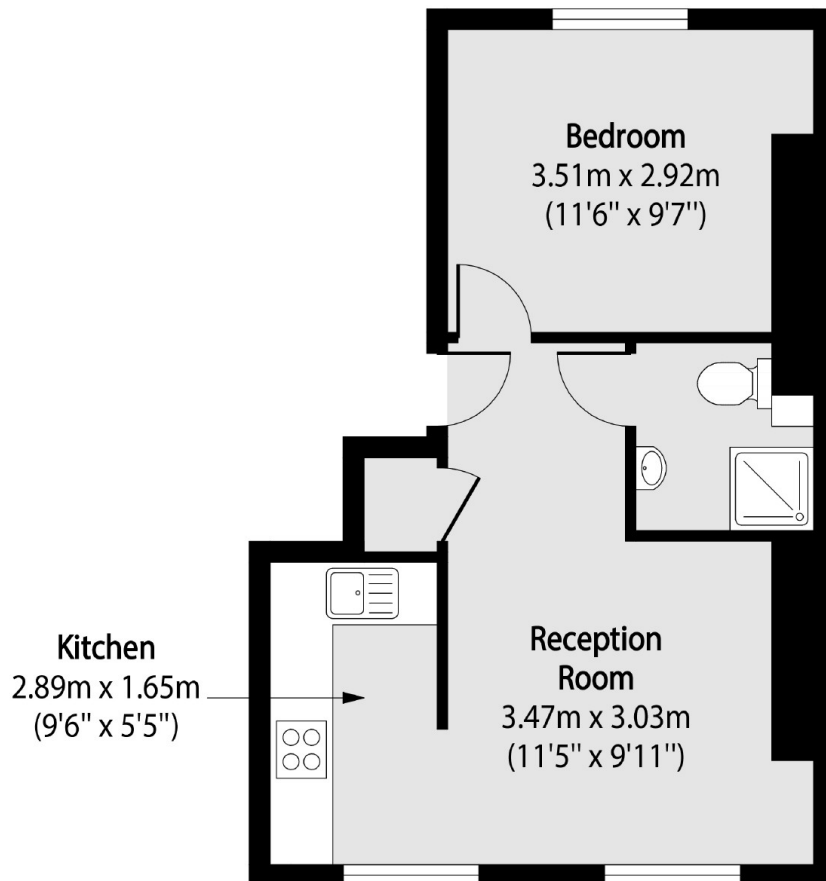

Total area (approx): 33.73 sq m (363 sq. ft)