



## Richmond Crescent, N1

### £850,000

A two bedroom garden flat on one of the most sought after crescents in Barnsbury. This Share of Freehold flat has a private entrance, private garden and is offered chain free.

Richmond Crescent, just off of Richmond Avenue is a wide tree lined street just moments from various green open spaces including Barnard Park. It benefits from the excellent transport links of King's Cross and amenities on Caledonian Road and Upper Street.

### Features

- Two Bedrooms
- Private Garden
- Period Conversion
- Private Entrance
- Chain Free
- Share of Freehold

# Richmond Crescent, London, N1

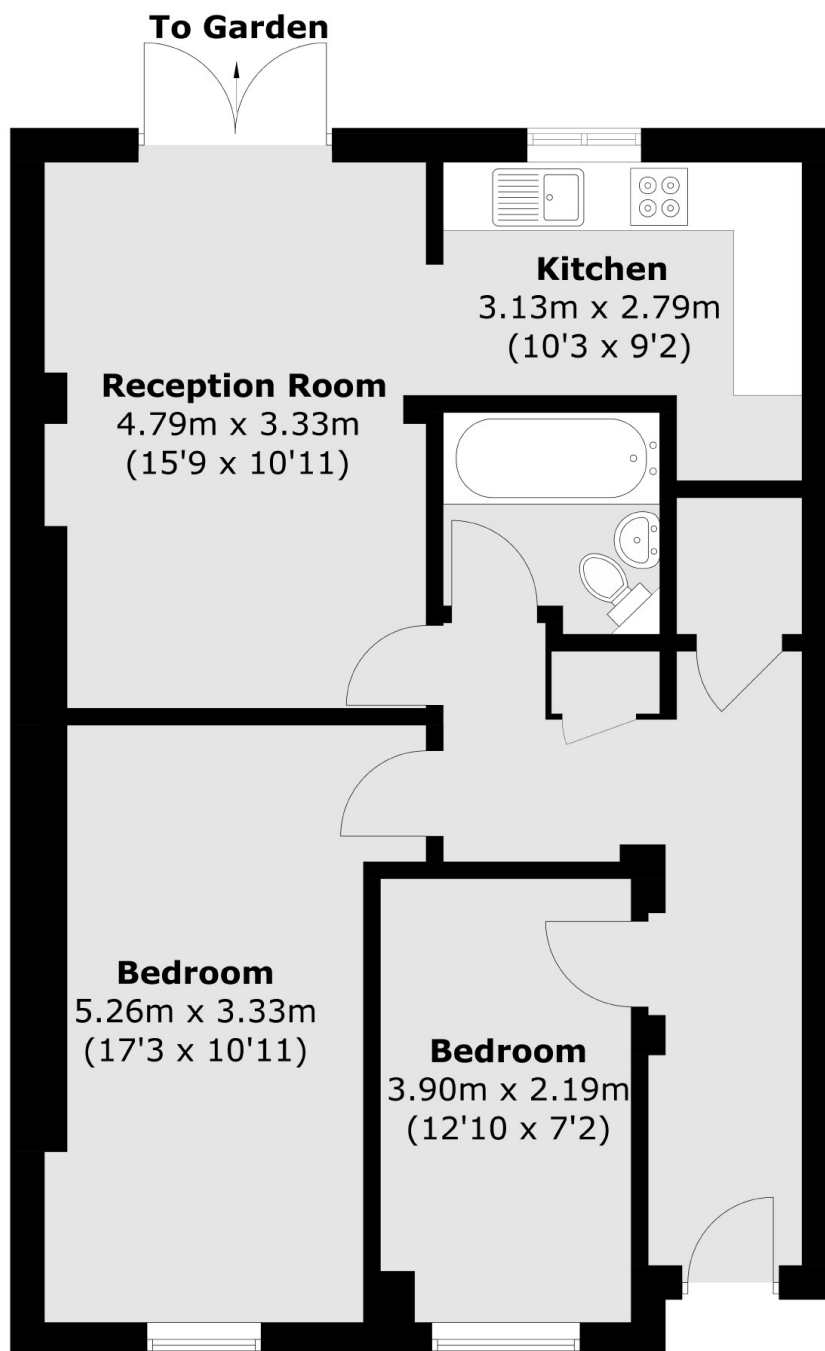

Total area (approx.): 67.5 sq. m (726.6 sq. ft)