



Highbury Quadrant, N5

£495,000

A generously proportioned two bedroom flat located on the third floor. Well looked after by the current owner, this home benefits from a private balcony, ample storage and lift access.

Ideally located close to the ever popular Clissold Park, and just a short walk to the shops, restaurants and cafés of Stoke Newington's Church Street. For transport, there are multiple bus routes along Green Lanes leading to the City and Arsenal station (Picadilly) is just over half a mile away.

Features

- Two Double Bedrooms
- Private Balcony
- Third Floor
- Lift Access
- Next to Clissold Park
- Good Storage

Highbury Quadrant, London, N5

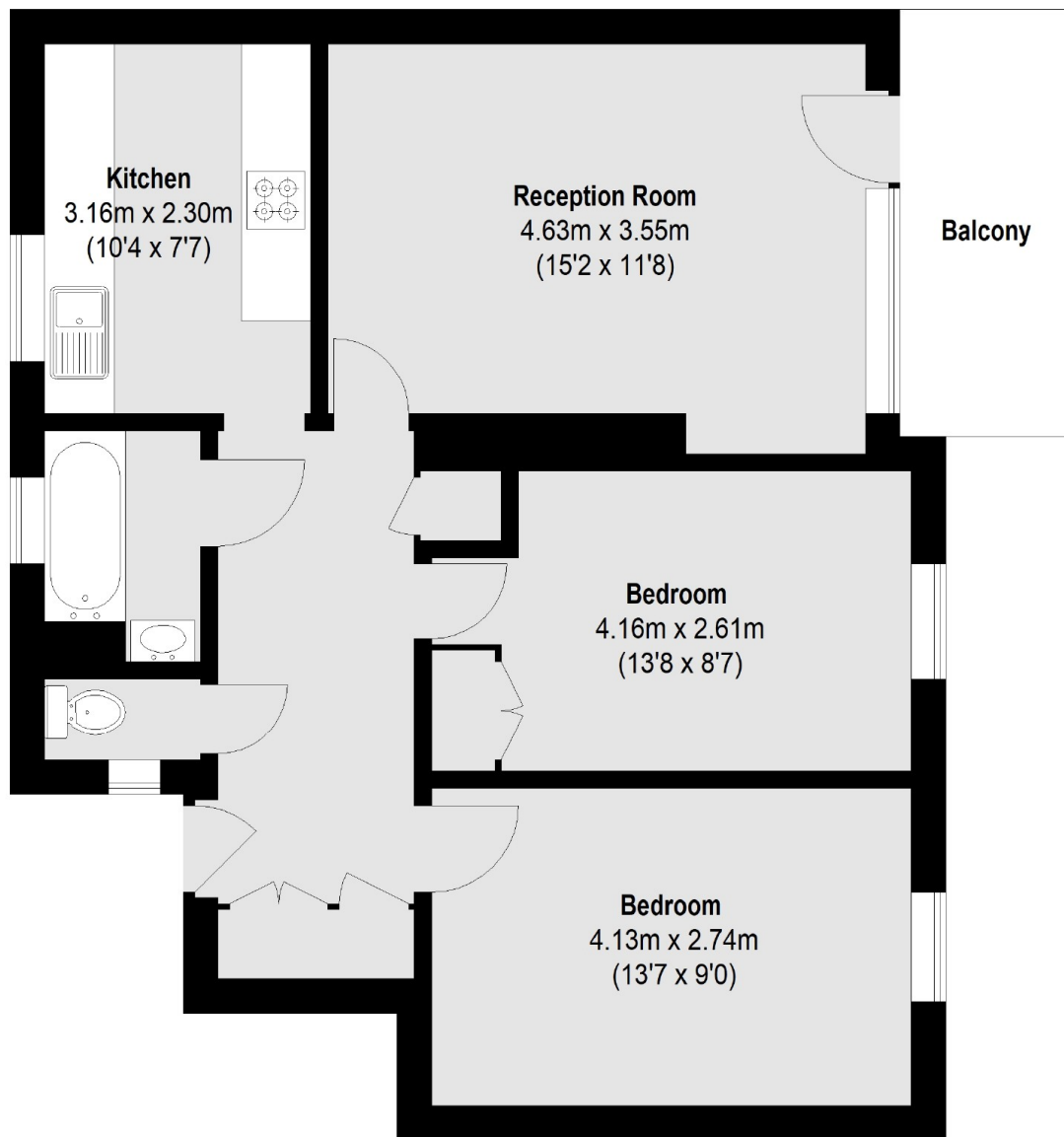

Third Floor

Total area (approx.): 61.32 sq. m (660 Sq. ft)
Balcony: 5.55 sq. m (60 Sq. ft)