



St. Pauls Road, N1

£425,000

A one bedroom flat set within a Victorian terrace conversion. This spacious home has hardwood floor, a private entrance and is being offered chain free.

Ideally located a short walk from the boutique delis, popular shops and cafés of Upper street. Canonbury Station (Overground) is close by, as well as having Highbury and Islington Station (Victoria line and Overground) at the end of the road.

Features

- One Bedroom
- Private Entrance
- Long Lease
- Chain Free
- Prime Islington Location

St. Pauls Road, London, N1

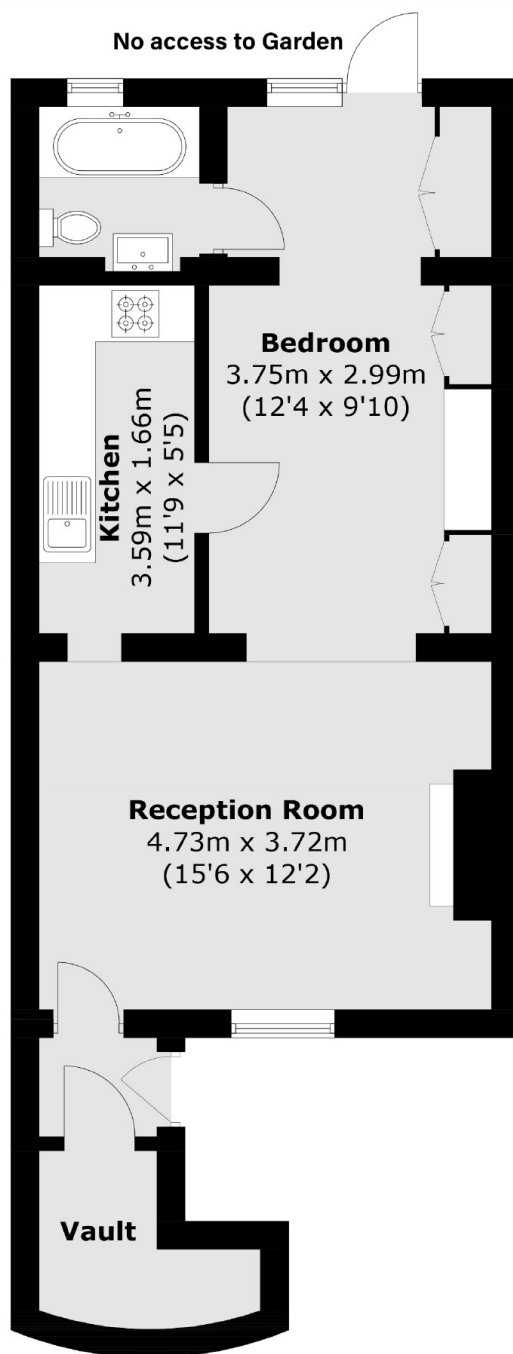

Lower Ground Floor

Total area (approx.): 51.3 sq. m (552.2 sq. ft)
(Including Vault)