



Highbury Station Road, N1

£1,200,000

This four double bedroom freehold terraced house offers over 1,175sq ft of space with a private South facing garden. Set over three floors, the property features two bathrooms, off street parking and is being offered chain free.

Highbury Station Road is an enviable location being close to tranquil Highbury Fields as well as the delights of Upper Street and the excellent transport links of Highbury & Islington station just 0.06 miles away.

Features

- Freehold House
- Four Double Bedrooms
- Private South Facing Garden
- Off Street Parking
- Two Bathrooms
- Close to Transport Links

Highbury Station Road, London, N1

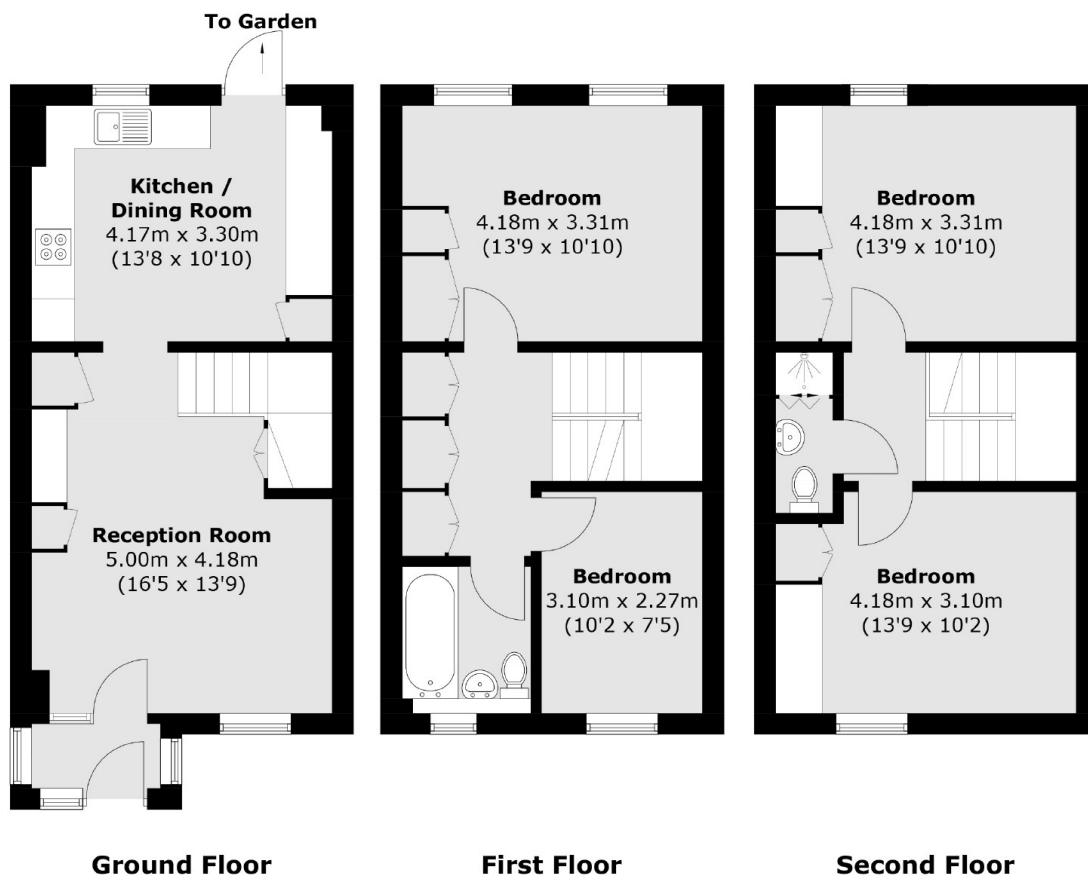

Total area (approx.): 109.2 sq. m (1175.5 sq. ft)