

Colin Dean Residential

in partnership with Dexters



Byron Road, HA3

£2,600 pcm

This well presented terraced family home offers generous living space throughout. Featuring four bedrooms with built in storage, two reception rooms and a separate kitchen equipped with integrated appliances and direct access onto a well maintained private garden. Perfectly suited for families, this home offers ample space and convenient living in a desirable location. Energy Rating: C.

The property is situated within close proximity to local shops, bus stops and popular schools nearby. Harrow & Wealdstone Station (Bakerloo line) is just 0.4 miles away, offering excellent transport links for added convenience.

- Terraced House • Four Bedrooms • Two Reception Rooms •
- Unfurnished • Private Garden • Central location •

Colin Dean Residential

in partnership with Dexters

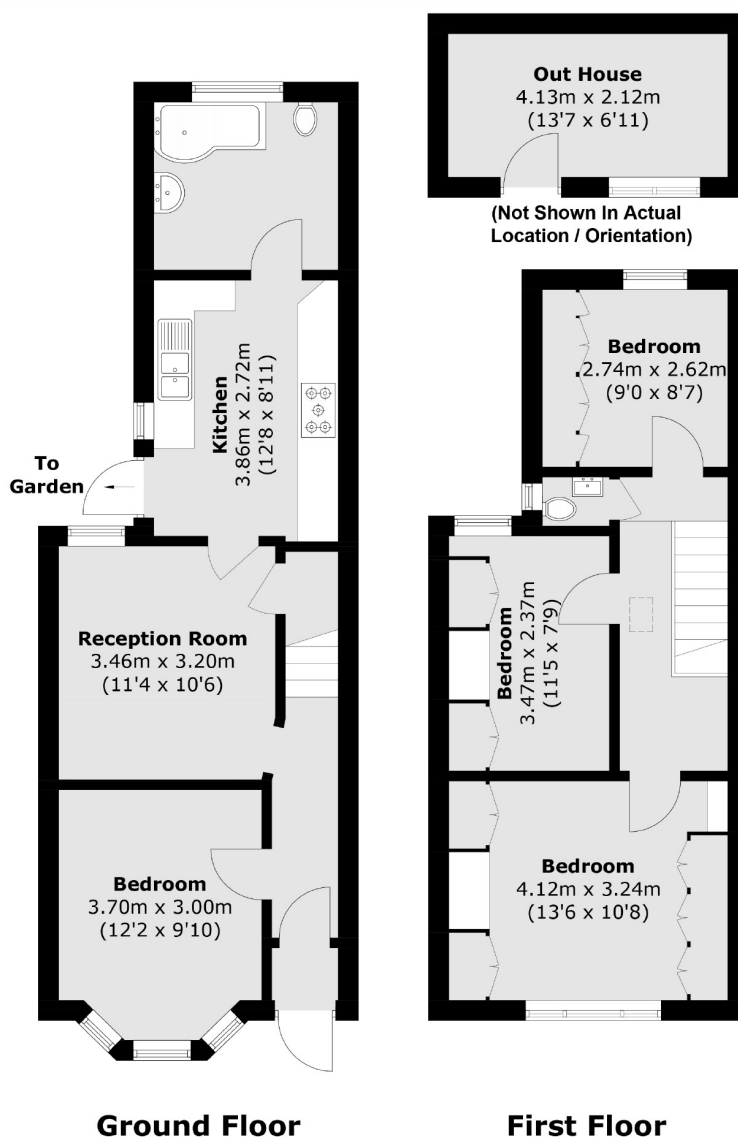

Total area (approx.): 85.0 sq. m (914.9 sq. ft)
Out House: 8.9 sq. m (95.8 sq. ft)

Colin Dean Residential
350 Pinner Road,
Harrow, HA1 4LB
020 8515 7929
daniel.murray@colindean.com

Energy Rating: C We aim to make our particulars both accurate and reliable. However they are not guaranteed; nor do they form part of an offer or contract. If you require clarification on any points then please contact us, especially if you're travelling some distance to view. Please note that appliances and heating systems have not been tested and therefore no warranties can be given as to their good working order.