

# Colin Dean Residential

in partnership with Dexters



## Dorset Road, HA1

£2,400 pcm

This beautifully presented three bedroom Semi-Detached family home includes a garage and off-street parking. The property offers two living rooms, a separate kitchen with integrated appliances and a utility room that opens onto its own private garden. Upstairs, there are three well proportioned bedrooms and a recently refurbished contemporary bathroom. This property is ideal for families looking for both comfort and convenience. Energy Rating: E.

The property is situated in a quiet residential street with local shops, bus stops and popular schools nearby. West Harrow station (Metropolitan line) is approximately 0.5 Miles away from this property.

- Three Bedrooms • Two Living Rooms • Modern Fitted Kitchen •
- Private Garden • Off Street Parking • Central Location •

# Colin Dean Residential

in partnership with Dexters

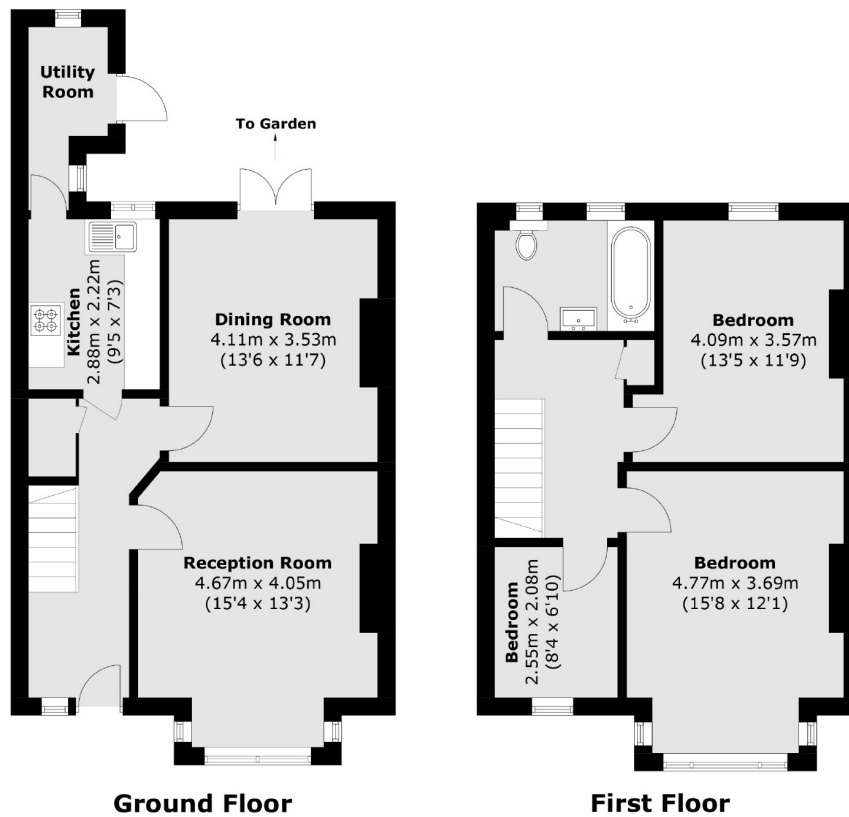

Total area (approx.): 103.4 sq. m (1,113.0 sq. ft)

Colin Dean Residential  
350 Pinner Road,  
Harrow, HA1 4LB  
020 8515 7929  
[enquiries@colindean.com](mailto:enquiries@colindean.com)

Energy Rating: E We aim to make our particulars both accurate and reliable. However they are not guaranteed; nor do they form part of an offer or contract. If you require clarification on any points then please contact us, especially if you're travelling some distance to view. Please note that appliances and heating systems have not been tested and therefore no warranties can be given as to their good working order.