

Colin Dean Residential

in partnership with Dexters



Ivy Close, HA2

£1,600 pcm

This neutrally decorated two bedroom ground floor flat offers a spacious reception room and separate kitchen leading out to a private rear garden. Perfect for a professional couple or small family. Energy Rating: D.

The property is situated in a quiet residential road and has local shops, bus stops and popular schools nearby. Both Northolt Park and South Ruislip train stations are approximately a mile away.

- Ground Floor Flat • Two Bedrooms • Recently Decorated •
- Unfurnished • Large Reception Room • Wooden Flooring •
- Private Garden •

Colin Dean Residential

in partnership with Dexters

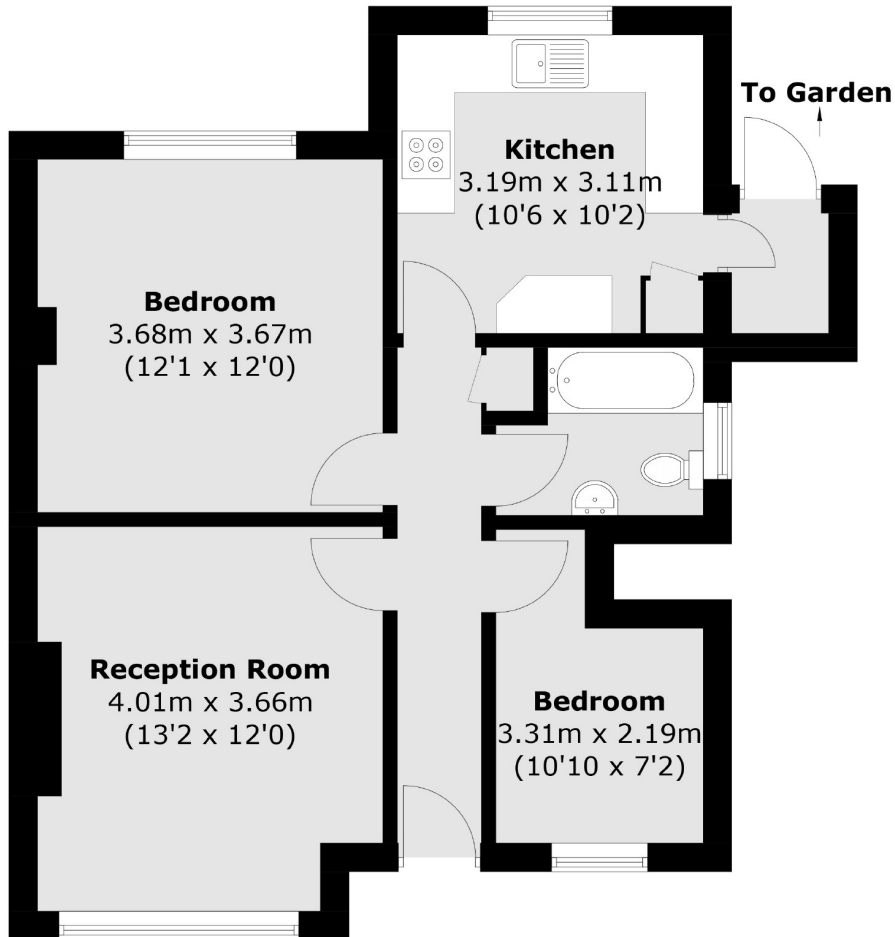

Total area (approx.): 56.2 sq. m (604.9 sq. ft)

Colin Dean Residential
350 Pinner Road,
Harrow, HA1 4LB
020 8515 7929
enquiries@colindean.com

Energy Rating: D We aim to make our particulars both accurate and reliable. However they are not guaranteed; nor do they form part of an offer or contract. If you require clarification on any points then please contact us, especially if you're travelling some distance to view. Please note that appliances and heating systems have not been tested and therefore no warranties can be given as to their good working order.