



86 Carter Drive

, Broadbridge Heath, RH12 3GZ

£350,000

Parkside are delighted to bring to the market this well presented 2 bedroom terrace house with allocated parking conveniently situated on the popular Wickhurst Green development, close to local amenities, excellent schools and with easy access to scenic countryside walks and Horsham town centre.

The accommodation comprises: entrance hallway, cloakroom, fully fitted kitchen with a range of attractive units and integrated appliances and living/dining room with french doors leading onto the garden. On the first floor there is a spacious principle bedroom with fitted wardrobes, further double bedroom and a modern family bathroom.

The property benefits from double glazing, gas fired central heating and fibre-optic broadband.
NO CHAIN
EPC B

The private rear garden is mainly laid to lawn with a patio area, shed and gate for rear access. There is allocated parking for one car to the front of the property.

- 2 DOUBLE BEDROOMS
- BUILT IN 2015 BY BOVIS HOMES
- CLOSE TO EXCELLENT SCHOOLS AND AMENITIES
- ALLOCATED PARKING
- POPULAR LOCATION
- MODERN KITCHEN & BATHROOM

Viewing

Please contact our Parkside Office on 01403 288745 if you wish to arrange a viewing appointment for this property or require further information.



Floor Plan

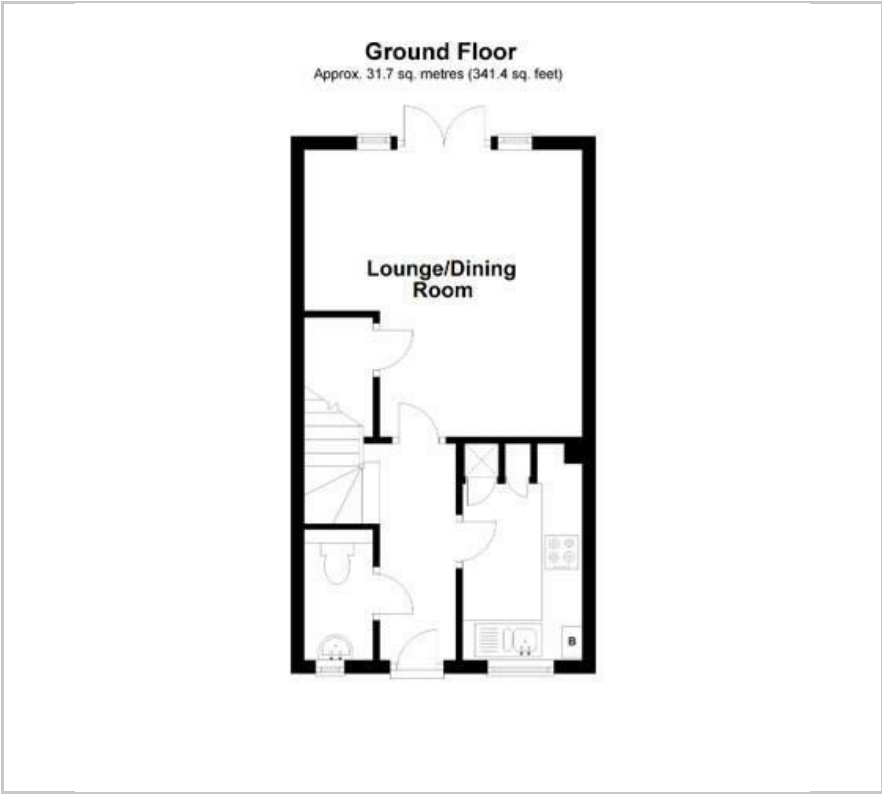

Area Map



Energy Efficiency Graph

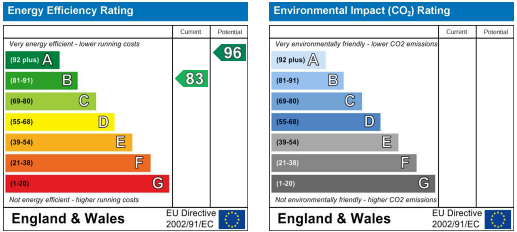

These particulars, whilst believed to be accurate are set out as a general outline only for guidance and do not constitute any part of an offer or contract. Intending purchasers should not rely on them as statements of representation of fact, but must satisfy themselves by inspection or otherwise as to their accuracy. No person in this firms employment has the authority to make or give any representation or warranty in respect of the property.