



Flat 4, Henmead House Renfields

, Haywards Heath, RH16 4WJ

£325,000

Parkside are delighted to bring to the market this beautifully presented two double bedroom ground floor apartment with balconies overlooking the woodland surroundings.

Accommodation comprises; spacious entrance hall with two generous storage cupboards, large open plan kitchen/living area with modern kitchen units, integrated appliances and plenty of storage space, ideal for entertaining and enjoying a relaxed lifestyle with the double aspect balconies flooding the room with natural light, large utility cupboard housing the washing machine. The generously sized double principle bedroom benefits from fitted wardrobes & an en suite, further good sized double bedroom and a well-appointed bathroom with over bath shower and modern white suite completes the accommodation.

The apartment benefits from double glazing, gas central heating, lift access to all floors, allocated underground parking and access to communal gardens.

Located in the highly desirable Tall trees/ Upper Village area of Bolnisi, just a short walk from the town centre, local amenities, parks, and excellent transport links, this apartment is ideal for professionals and young families alike.

EPC B
Council Tax - D
Tenure: Leasehold - 125 years from 01.01.2015.
Ground Rent: £250 per year with reviews every 10 years
Service Charge - £1678 maintenance charge including building insurance

Viewing

Please contact our Parkside Office on 01403 288745 if you wish to arrange a viewing appointment for this property or require further information.

- Large open plan living area with balconies
- Ground floor
- Allocated undercover parking
- Lift access to all floors & parking
- Double glazed
- Gas central heating
- En suite



Floor Plan

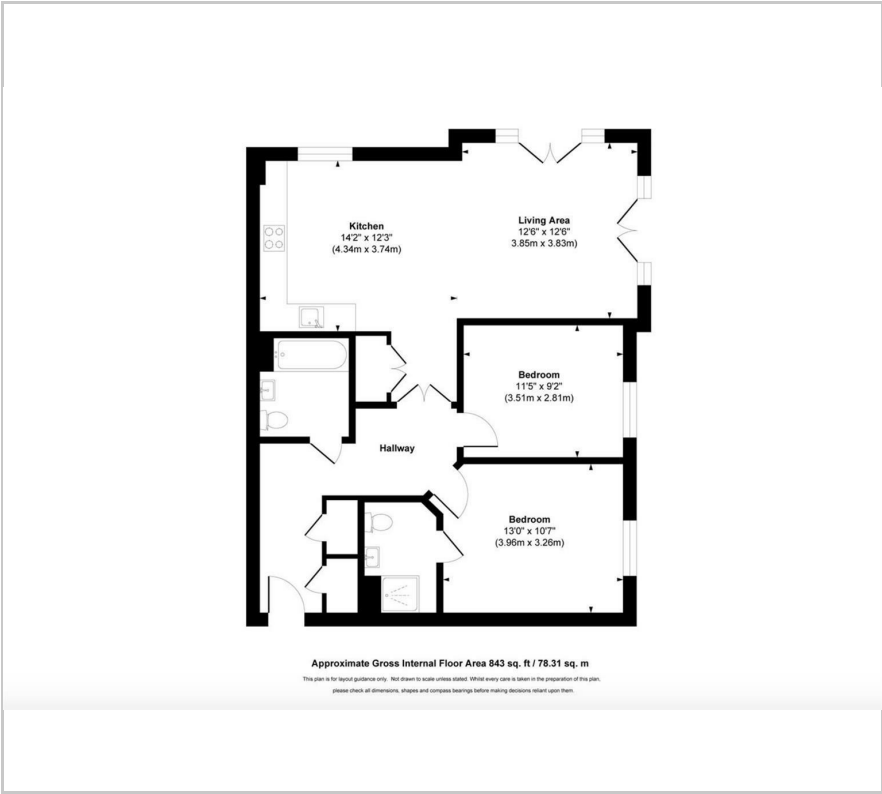

Area Map



Energy Efficiency Graph

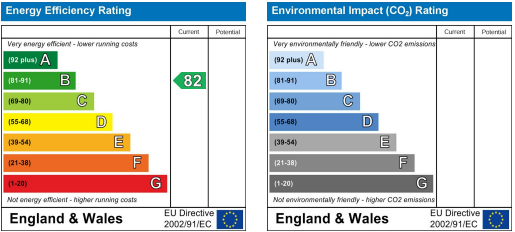

These particulars, whilst believed to be accurate are set out as a general outline only for guidance and do not constitute any part of an offer or contract. Intending purchasers should not rely on them as statements of representation of fact, but must satisfy themselves by inspection or otherwise as to their accuracy. No person in this firms employment has the authority to make or give any representation or warranty in respect of the property.