



Joseph Hardcastle Close, SE14

£725,000

Stunning three bedroom end of terrace house to let in the sought after John Williams Close and just 0.3 miles from New Cross Station. The property is very well presented with one single, one double, and a larger than average master bedroom with walk in wardrobe, en-suite shower room and a separate family bathroom. On the ground level is a very large reception room, kitchen/diner, W.C. And rear garden.

Features

- Three Bedrooms
- Freehold
- Driveway
- Modern Features
- No Onward Chain
- Semi Detached



Joseph Hardcastle Close, SE14



Joseph Hardcastle Close, London, SE14

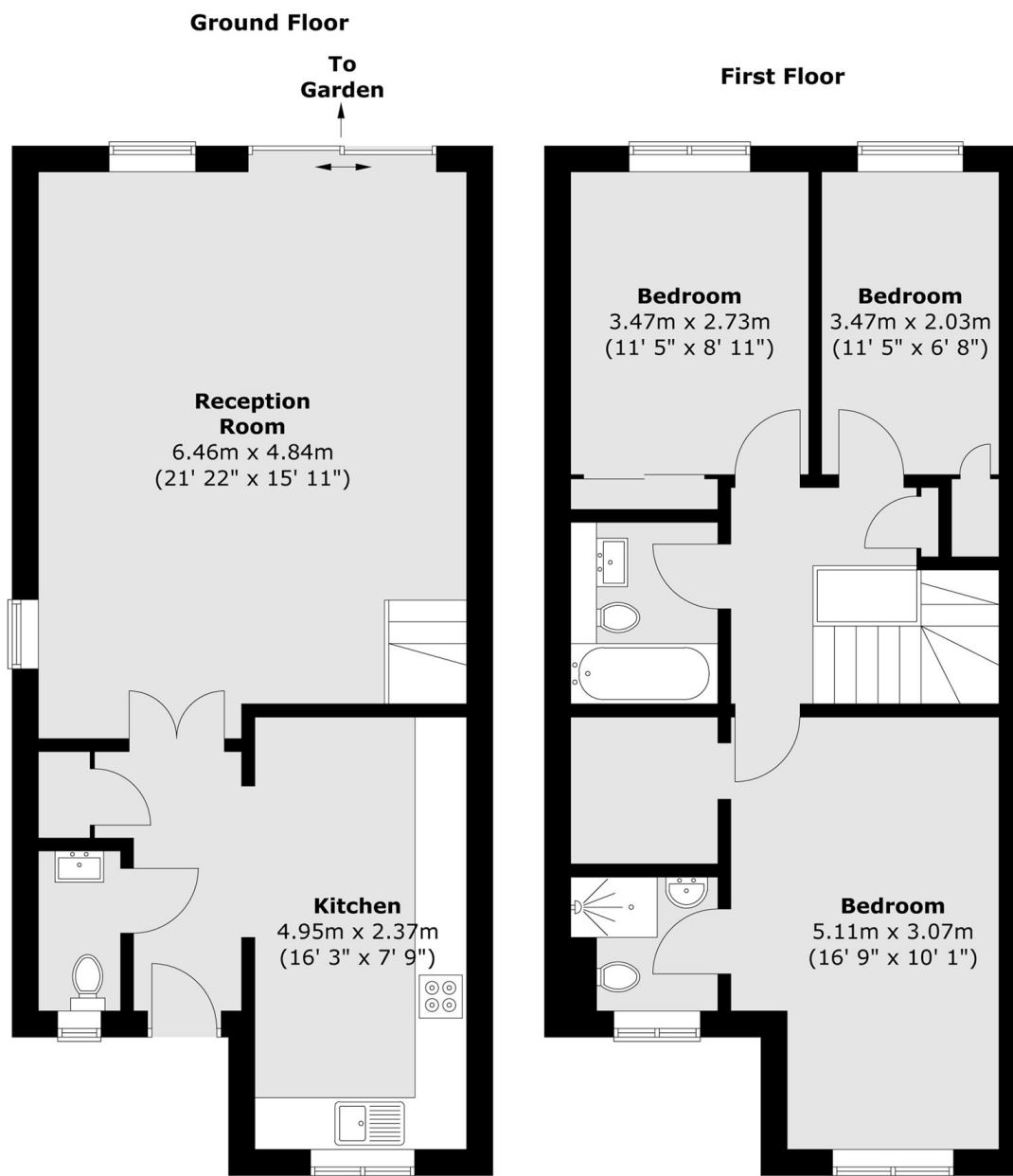

Total area (approx.) : 104.5 sq. m (1125 sq. ft)