



New Cross Road, SE14

£1,750 Per calendar month

A two bedroom Victorian conversion on New Cross Road. Including an open living space, modern features and ample storage throughout.

Located on New Cross Road you are within walking distance to New Cross and New Cross Gate stations as well as all the amenities that New Cross Road has to offer.

Features

Victorian Conversion Flat
Two Double Bedrooms
Open Plan Living Space
Modern Features Throughout
Close To Stations
Unfurnished

New Cross Road, London, SE14

- (S) Smoke Alarm (BL) Boiler
(H) Heat Detector (CM) Carbon Monoxide

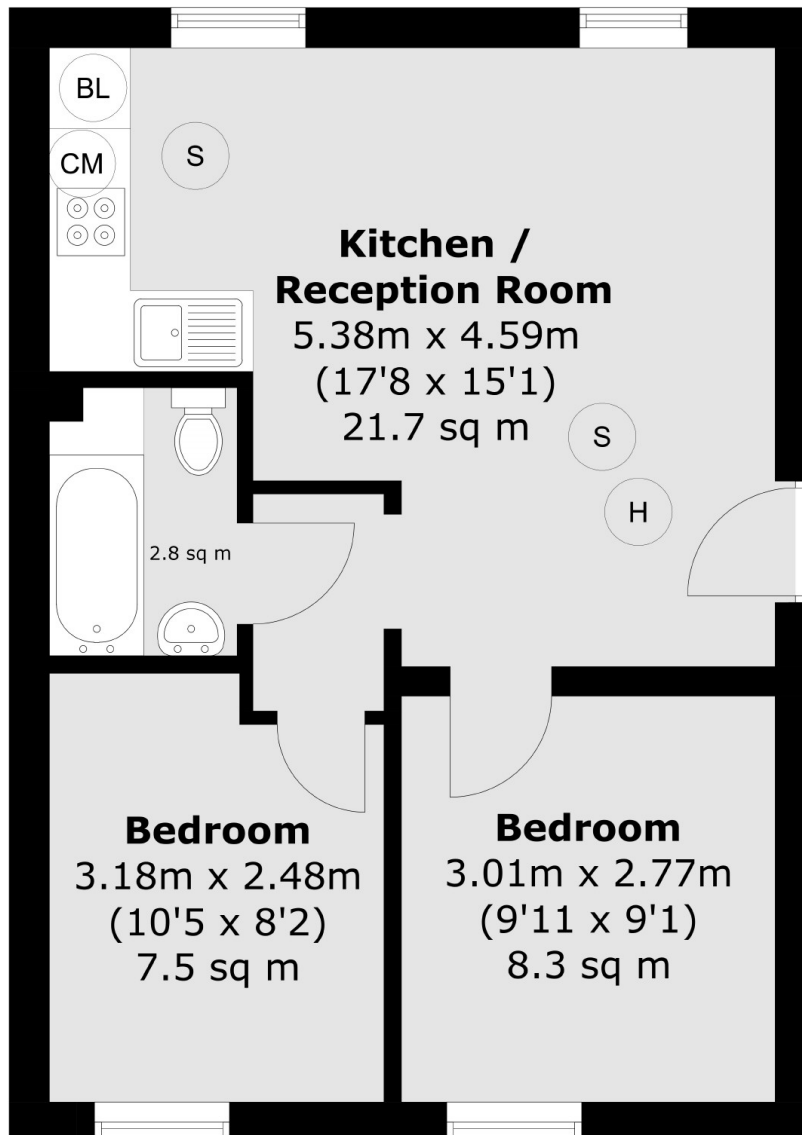

Total area (approx.): 42.2 sq. m (454.2 sq. ft)