



Manor Avenue, SE4

£425,000

Nestled on one of Brockley's most sought-after streets, this charming one-bedroom flat on Manor Avenue blends period character with modern living. Set within a beautiful Victorian conversion, the property offers a perfect retreat for first-time buyers, professionals, or investors alike. The flat boasts a bright and spacious reception room with high ceilings, large sash windows, and original features that provide a warm and elegant feel. The modern kitchen is well-equipped with integrated appliances and sleek cabinetry, ideal for home cooking or entertaining guests. There is also a separate, private room within the building, which makes the perfect office for those that work at home.

Features

- One Bedroom
- Victorian Conversion
- Brockley Conservation Area
- Close To Transport Links
- Green Views
- Separate Office Space



Manor Avenue, SE4

The double bedroom is generously sized and offers a peaceful view over the rear gardens, while the contemporary bathroom is finished to a high standard with quality fittings.

Manor Avenue is a quiet, tree-lined road located in the Brockley Conservation Area, just a short walk from Brockley Station (Zone 2), offering easy access to London Bridge, Shoreditch, and the City via Overground and National Rail services. The vibrant local community offers independent cafes, restaurants, and weekend markets, all within walking distance.



Manor Avenue, London, SE4

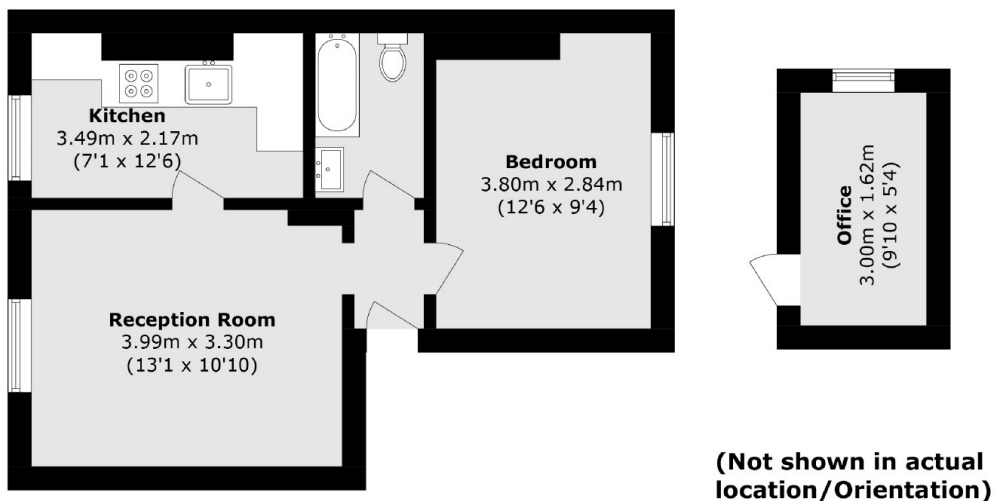

Ground Floor

Total area (approx.): 37.2 sq. m (400.4 sq. ft)
Outbuilding (approx.): 4.8 sq. m (51.6 sq. ft)