



Kitto Road, SE14

£1,800,000

Elegant 4 Bedroom Victorian End-of-Terrace in sought after Telegraph Hill, SE14 with 2,143 sq ft of internal space and City Views.

Nestled on a tree-lined street in the heart of Telegraph Hill and with views of both Telegraph Hill Parks, this substantial 4 bedroom end-of-terrace Victorian home offers an exceptional blend of period charm, generous proportions, and modern potential. Spanning an impressive 2,143 sq ft, the property presents a rare opportunity to acquire a family home with stunning Skyline views and scope for further improvements.

Features

End Of Terrace Family Home
Four/Five Bedrooms
London Skyline Views
Telegraph Hill Conservation Area
Garage And Off Street Parking
Three Storeys



Kitto Road, SE14

Set across three floors, the house boasts original architectural features such as high ceilings, and large sash windows that flood the space with natural light. The hall floor offers a versatile layout with a spacious double reception room ideal for entertaining, as well as a fourth bedroom with views of the London skyline. The first floor provides three large double bedrooms, including a principal bedroom with stunning views of Telegraph Hill Upper Park. Furthermore, there are stunning London Skyline views to the rear.

The flexible layout also provides the space to have a separate dining room, as well as an office/fifth bedroom, or if you wished, to create a self contained one bedroom apartment to the lower floor, which has the potential to bring in around £1500 pcm of rental (subject to relevant consents).

Additional highlights include two family bathrooms, side access and a garage providing rare off street parking.



Kitto Road, London, SE14

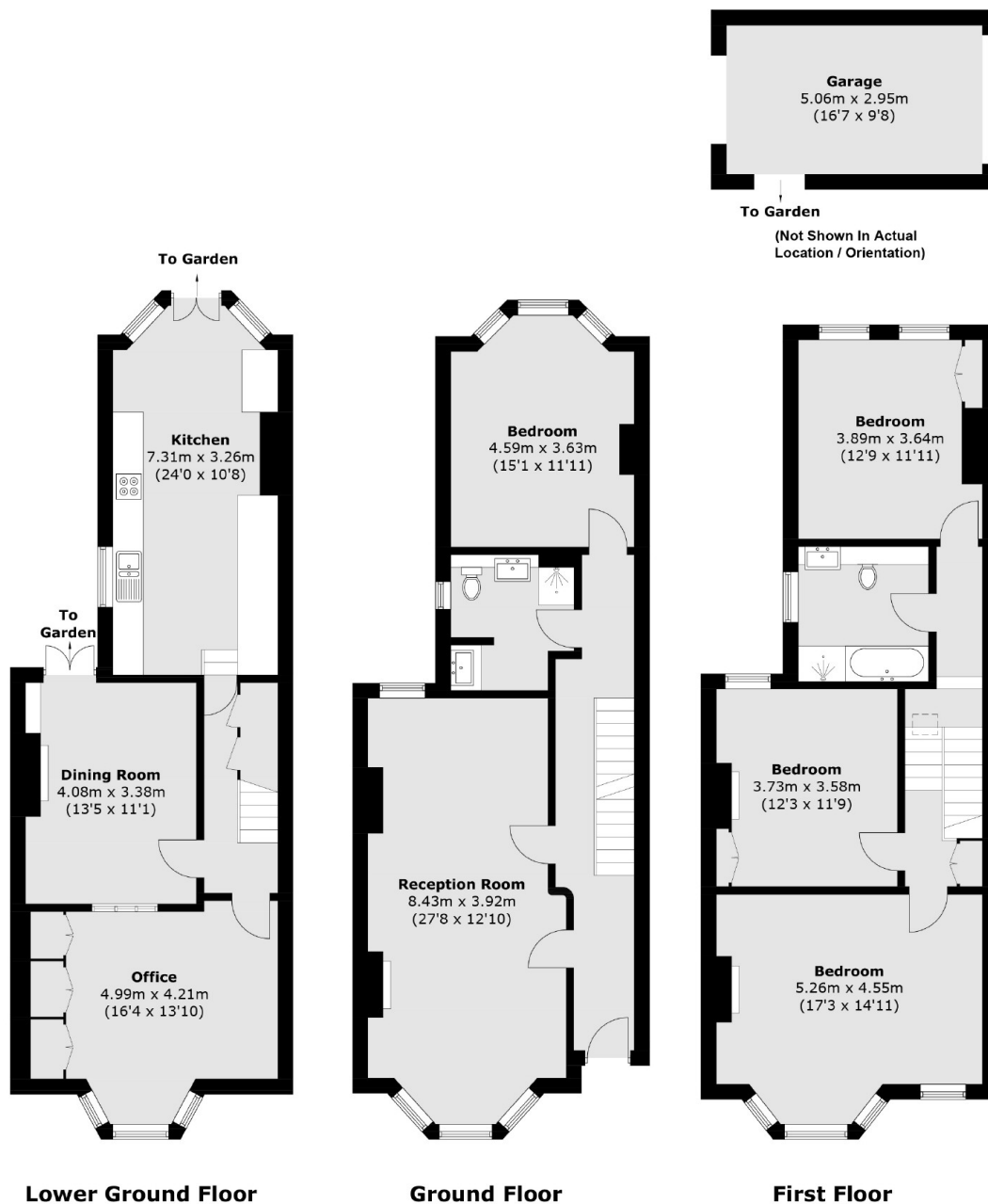

Total area (approx.): 199.1 sq. m (2,143.1 sq. ft)
Garage: 14.9 sq. m (160.4 sq. ft)

Dexters

New Cross
256 New Cross Road
London
SE14 5PL
Sales
020 7313 3660

Energy Rating: E. We aim to make our particulars both accurate and reliable. However they are not guaranteed; nor do they form part of an offer or contract. If you require clarification on any points then please contact us, especially if you're traveling some distance to view. Please note that appliances and heating systems have not been tested and therefore no warranties can be given as to their good working order.

RICS Regulated
Estate Agent
and Letting Agent

dexters.co.uk