



Reaston Street, SE14

£325,000

No Chain. Bright and spacious one double bedroom apartment located close to New Cross. Situated on the top floor of this modern development, there is a large open plan kitchen and reception area with doors on to a large private terrace.

Reaston Street is located approximately half a mile from New Cross gate station providing access to central London in around 15 minutes. There are multiple Cafes, bars and boutique eateries nearby.

Features

- Chain Free
- One Double Bedroom
- Top Floor Large Terrace
- Close To Transport
- Bright And Spacious
- Good Condition Throughout

Reaston Street,
London, SE14

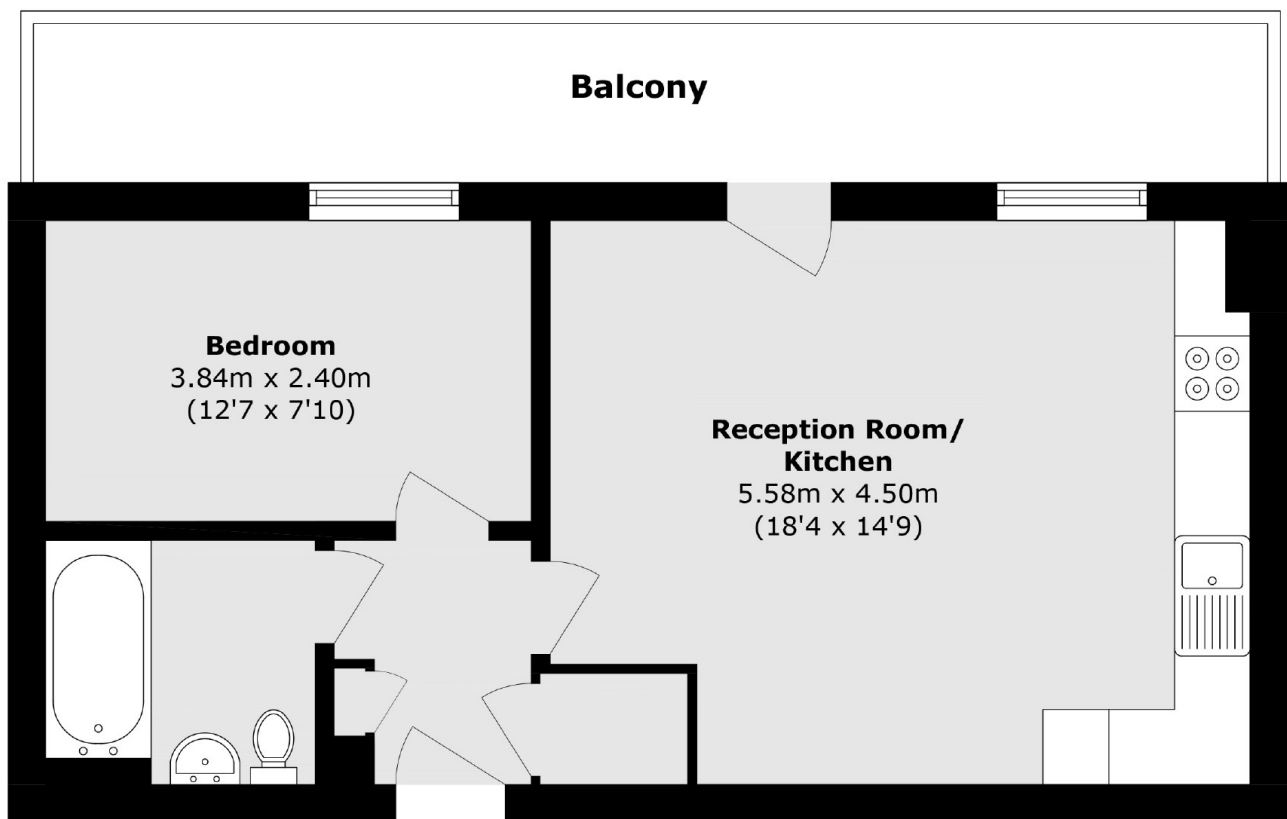

Total area (approx.): 43.2 sq. m (465.0 sq. ft)
Balcony area (approx.): 12.4 sq. m (133.4 sq. ft)

Dexters

New Cross
256 New Cross Road
London
SE14 5PL
Sales
020 7313 3660

Energy Rating: B. We aim to make our particulars both accurate and reliable. However they are not guaranteed; nor do they form part of an offer or contract. If you require clarification on any points then please contact us, especially if you're traveling some distance to view. Please note that appliances and heating systems have not been tested and therefore no warranties can be given as to their good working order.

 **RICS** | Regulated
Estate Agent
and Letting Agent

dexters.co.uk