



Upper Brockley Road, SE4 £850,000

Fantastic three bedroom Victorian terraced home located within the prestigious Brockley Conservation Area. With over 1100 Sq Ft of living space, this bright and spacious home would benefit from modernisation and so is the perfect blank canvas for someone looking to buy their family home. With the potential for extension and conversions (subject to planning consent) this really could become a spectacular property.

Upper Brockley Road is one of the conservation areas best roads. This home is located less than a 5 minute walk to Brockley Overground Station as well as Brockley Village with its various boutique style cafés, bar and restaurants.

Features

- Three Bedrooms
- Victorian Terraced Home
- Close To Brockley Village
- Conservation Area
- 1100 Sq Ft Of Living Space
- Private Rear Garden

Upper Brockley Road, London, SE4

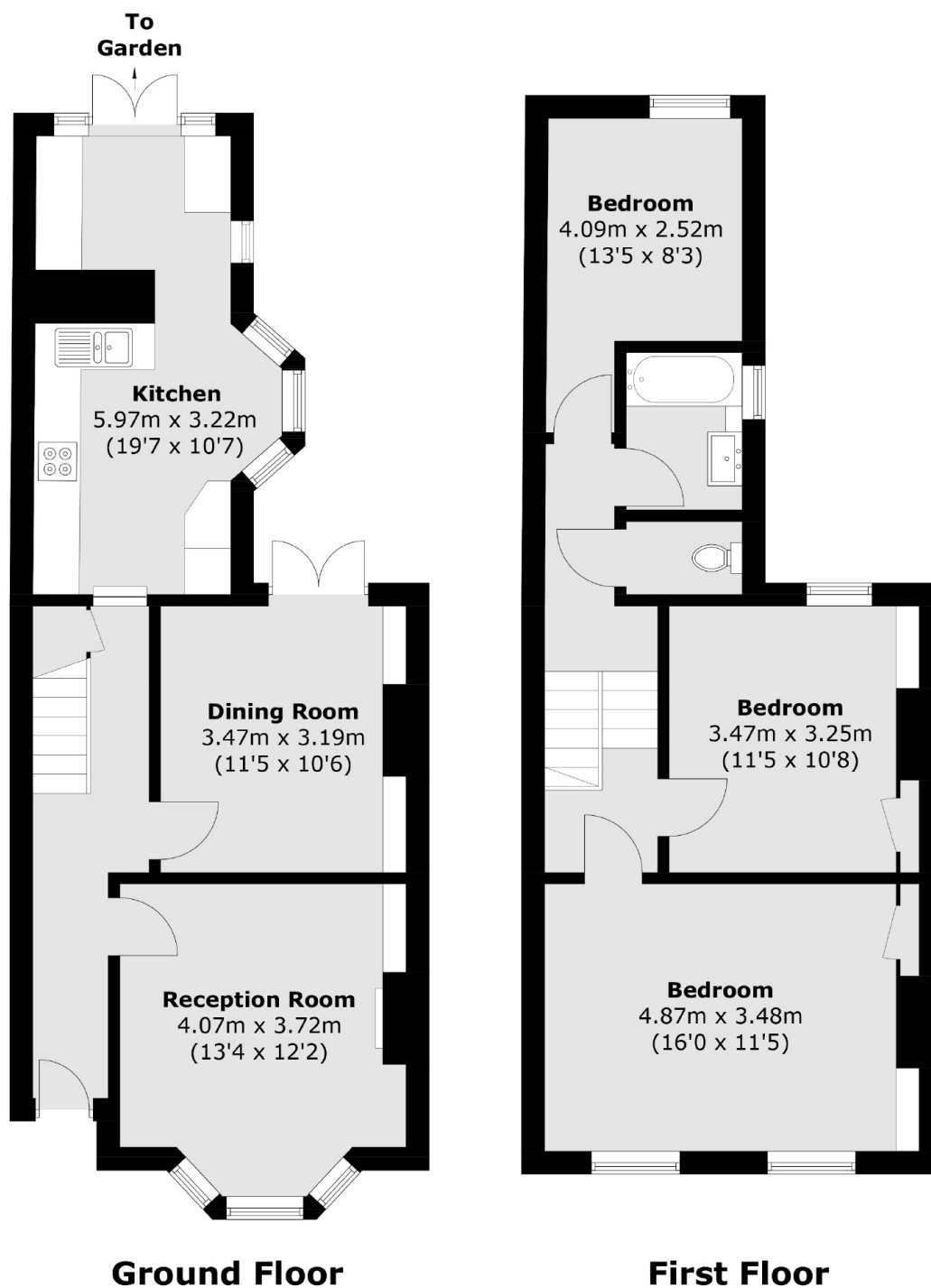

Total area (approx.): 102.3 sq. m (1,101.1 sq. ft)