



## Upper Brockley Road, SE4 £950,000

Fantastic three bedroom Victorian terraced home located within the prestigious Brockley Conservation Area. With over 1100 Sq Ft of living space, this bright and spacious home would benefit from modernisation and so is the perfect blank canvas for someone looking to buy their family home. With the potential for extension and conversions (subject to planning consent) this really could become a spectacular property.

Upper Brockley Road is one of the conservation areas best roads. This home is located less than a 5 minute walk to Brockley Overground Station as well as Brockley Village with its various boutique style cafés, bar and restaurants.

### Features

Three Bedrooms  
Victorian Terraced Home  
Close To Brockley Village  
Conservation Area  
1100 Sq Ft Of Living Space  
Private Rear Garden

# Upper Brockley Road, London, SE4

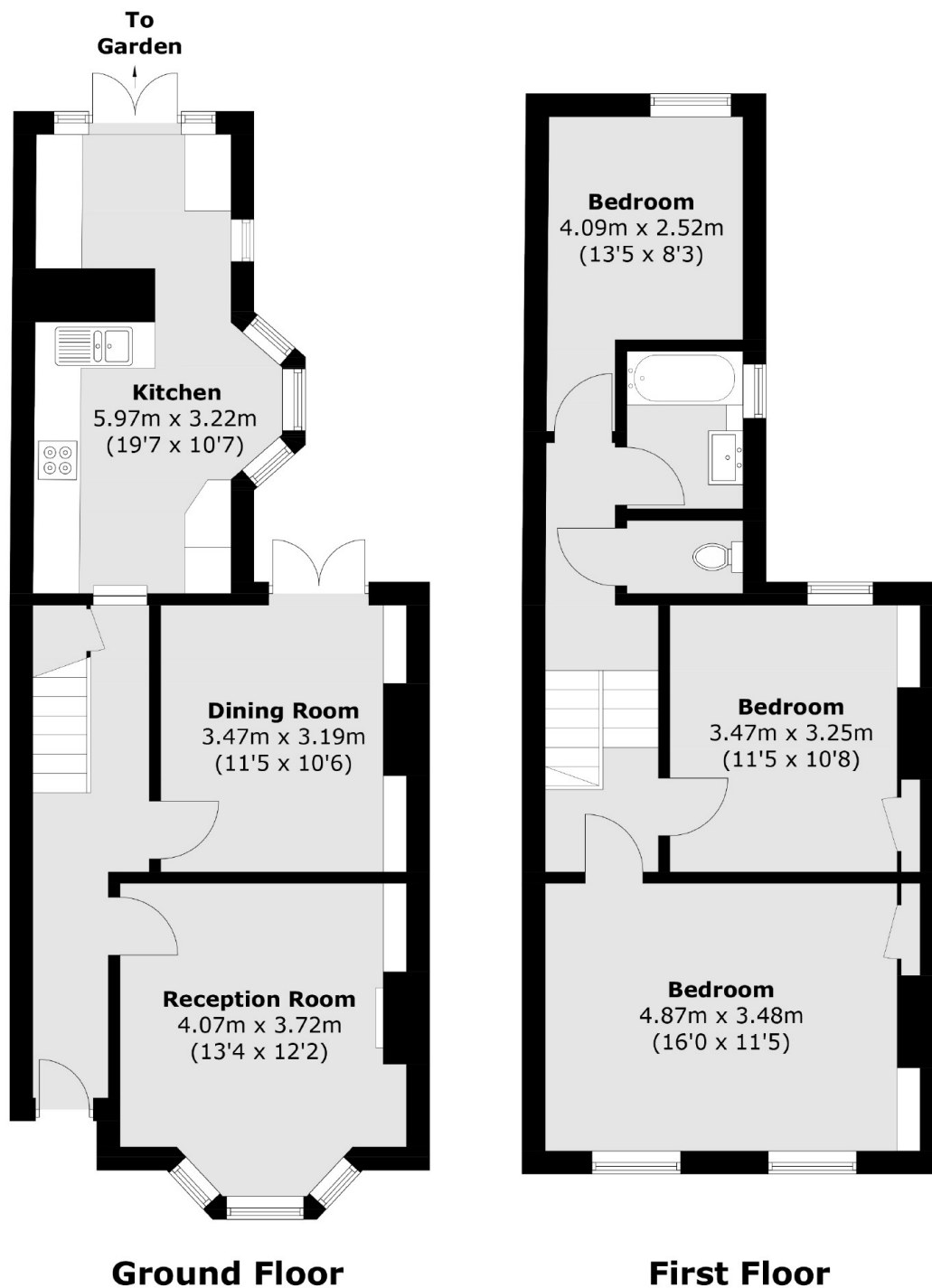

Total area (approx.): 102.3 sq. m (1,101.1 sq. ft)