



Florence Road, SE14

£550,000

Bright, spacious and modern three bedroom, two bathroom apartment. This fantastic property is offered to the market in excellent condition throughout, recently refurbished and comprising entrance hall, large living room open plan to modern fitted kitchen, three double bedrooms, family bathroom and en-suite shower room. To the rear is a sunny private courtyard garden.

Florence Road is located within easy reach of four stations, including New Cross mainline and Overground station and Deptford Bridge DLR. All are in zone 2, offering quick, convenient journeys to central London, the City and Canary Wharf. Royal Historic Greenwich is close by and bustling urban Deptford market is just around the corner. In addition, every conceivable amenity, including shops, bars and restaurants can be found up and down New Cross Road, all within walking distance.

Features

- Three Double Bedrooms
- Private Courtyard Garden
- Large Open Plan Kitchen/Living Space
- Close To Transport
- Two Bathrooms
- Bright And Spacious

Florence Road,
London, SE14

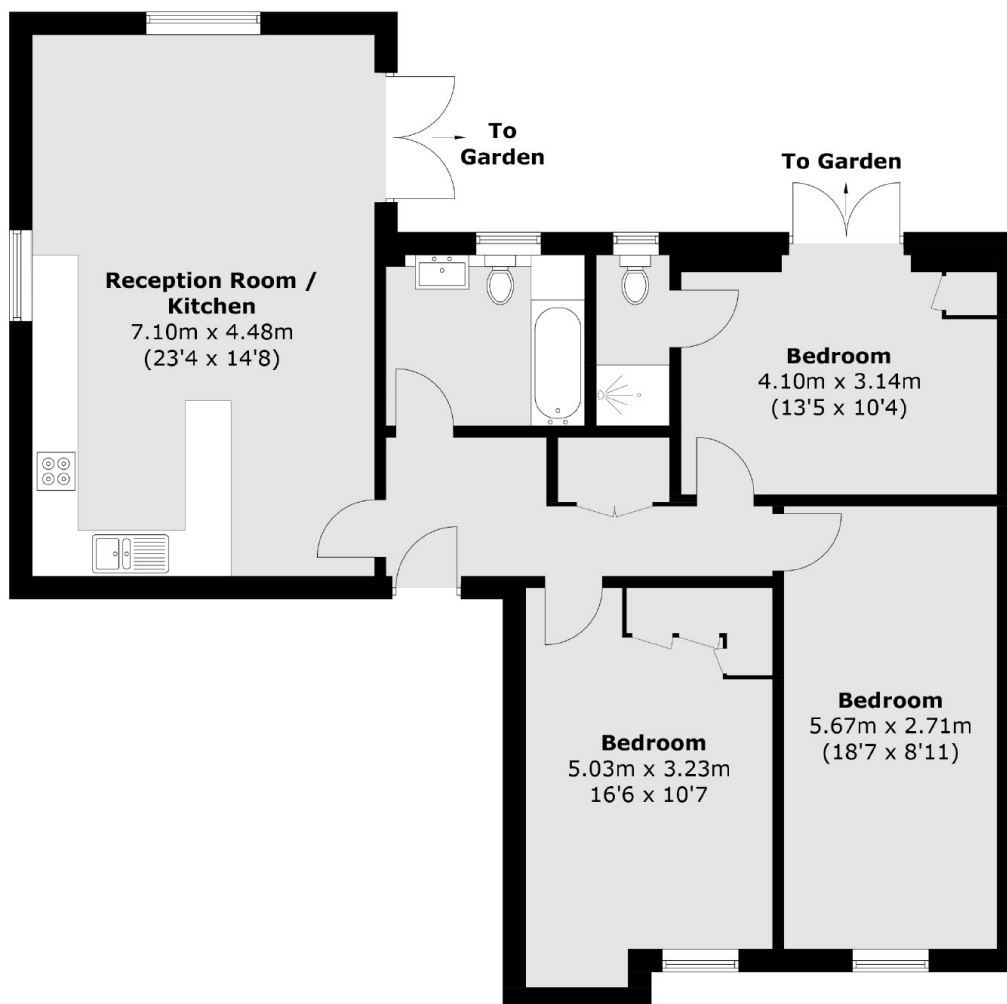

Basement

Total area (approx.): 97.6 sq. m (1,050.5 sq. ft)

Dexters

New Cross
256 New Cross Road
London
SE14 5PL
Sales
020 7313 3660

Energy Rating: TBC. We aim to make our particulars both accurate and reliable. However they are not guaranteed; nor do they form part of an offer or contract. If you require clarification on any points then please contact us, especially if you're traveling some distance to view. Please note that appliances and heating systems have not been tested and therefore no warranties can be given as to their good working order.

 **RICS** | Regulated
Estate Agent
and Letting Agent

dexters.co.uk