



New Cross Road, SE14

£475,000

This spacious two bedroom apartment is now available. This home comes with two double bedrooms, two bathrooms, open plan kitchen living area and comes with a long lease. This property further benefits from being a share of Freehold.

Features

- Two Bedrooms
- Share of Freehold
- Great Condition
- Gated Access
- En Suite
- Open Plan Kitchen

New Cross Road,
London, SE14

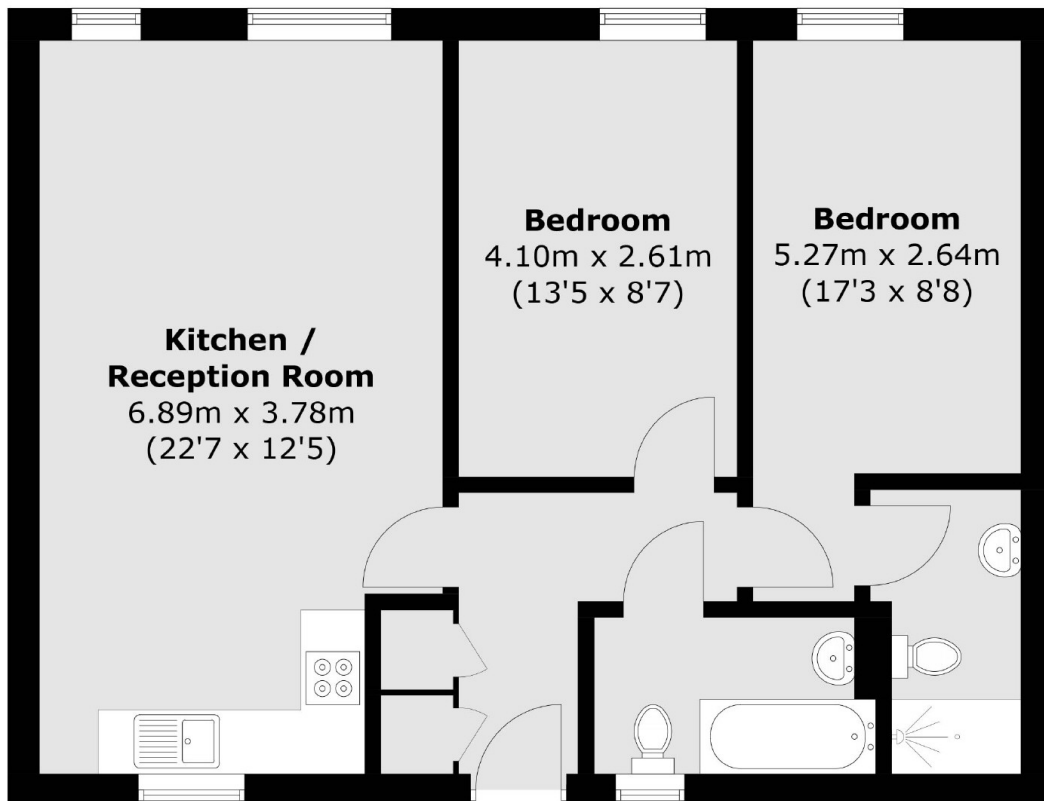

Total area (approx.): 63.5 sq. m (683.5 sq. ft)