



New Cross Road, SE14

£210,000

This one bedroom apartment offers ample living space in need of modernisation, the property is offered with no onward chain and would be ideal for first time buyers and investors.

Located on New Cross Road, you are within walking distance to New Cross and New Cross Gate stations as well as all the amenities that New Cross Road has to offer.

Features

- One Bedroom
- Needs Modernisation
- No Onward Chain
- Great Location
- Nearby Amenities
- Period Building

New Cross Road, London, SE14

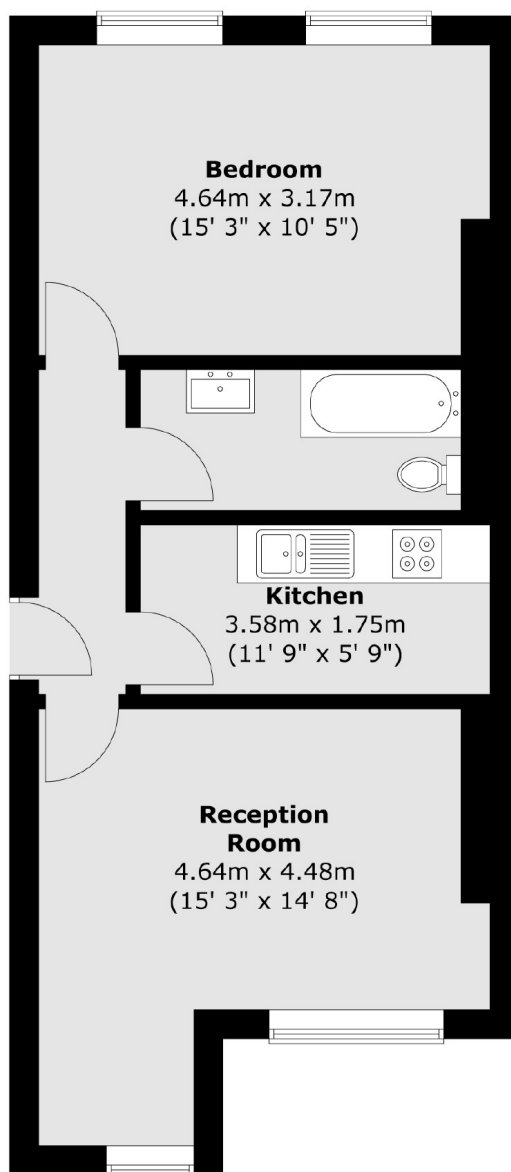

Total area (approx.) : 48.7 sq. m (524 sq. ft)