



Rotherhithe New Road, SE16

£500,000

Chancellor House is a brand new development in the heart of trendy South Bermondsey. Two double bedrooms, two bathrooms, and a spacious balcony with views across London. The development also has a resident's gym, concierge service and a large communal roof terrace.

The development is just half a mile from South Bermondsey Overground which links to London Bridge in just 7 minutes. Great bus links from Old Kent Road provide easy access to the Bakerloo Line.

Features

- Two Double Bedrooms
- Two Bathrooms
- Stunning Views
- Communal Roof Terrace
- Concierge
- On Site Gym

Rotherhithe New Road,
London, SE16

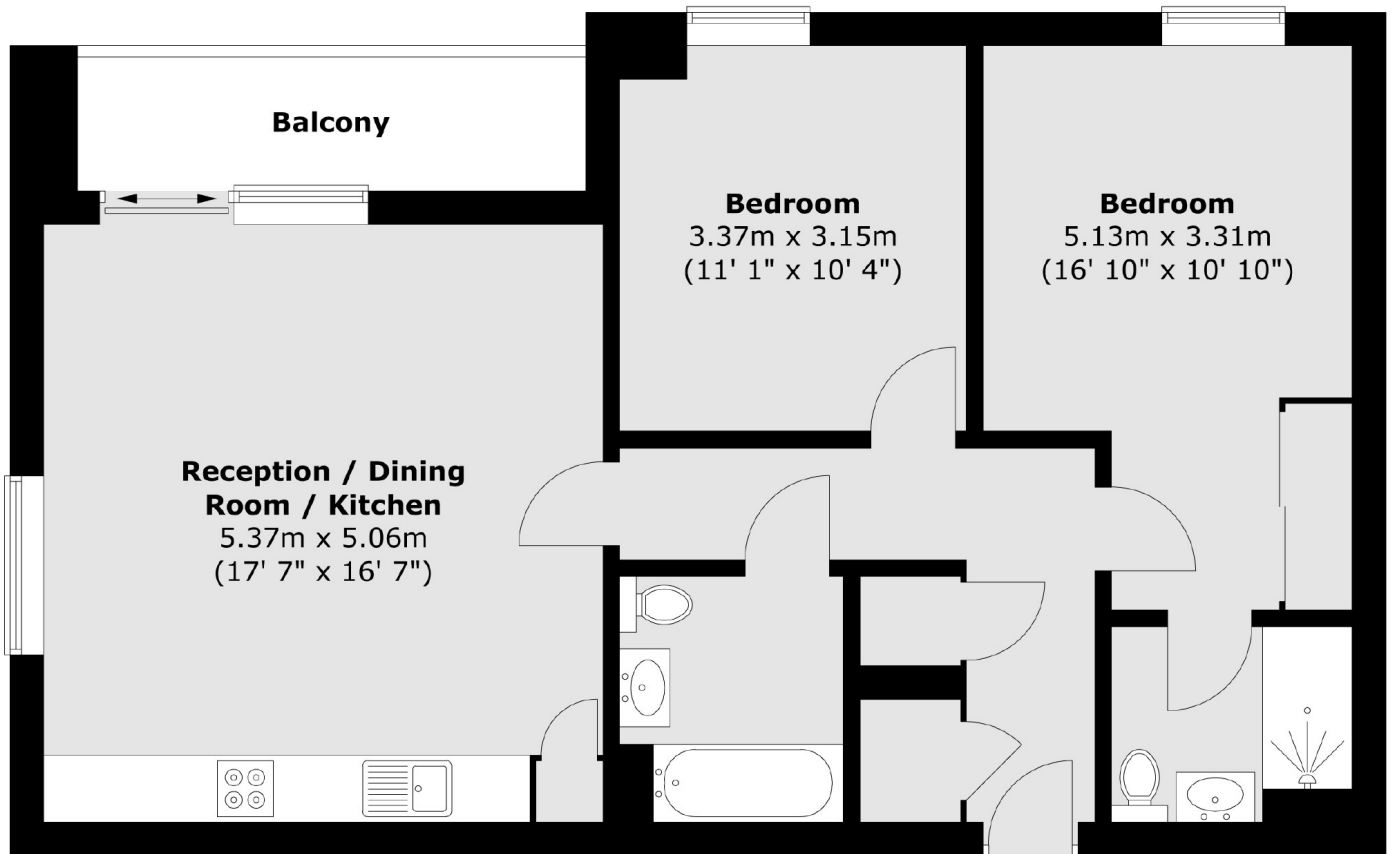

Total area (approx.) : 73.5 sq. m (791 sq. ft)
Total balcony area (approx.) : 5.5 sq. m (59 sq. ft)