



## Finland Road, SE4

£975,000

A substantial 3/4 bedroom Victorian home nestled away on a sought after road in Brockley. The property is offered in great condition has a private garden and is finished in a contemporary style.

Finland Road is a highly sought after residential street that is conveniently located for both Brockley and Nunhead train stations giving easy access into the City. There are two outstanding local schools, Haberdasher's Askes and John Stainer, with Brockley Station a mere three minute walk. At the end of the road there is a popular local café, Good As Gold, with numerous cafés, restaurants and bars a short walk away.

### Features

- Victorian Home
- Three Double Bedrooms
- Immaculate Condition
- Private Garden
- Sought After Road
- Excellent Transport Links

# Finland Road, London, SE4

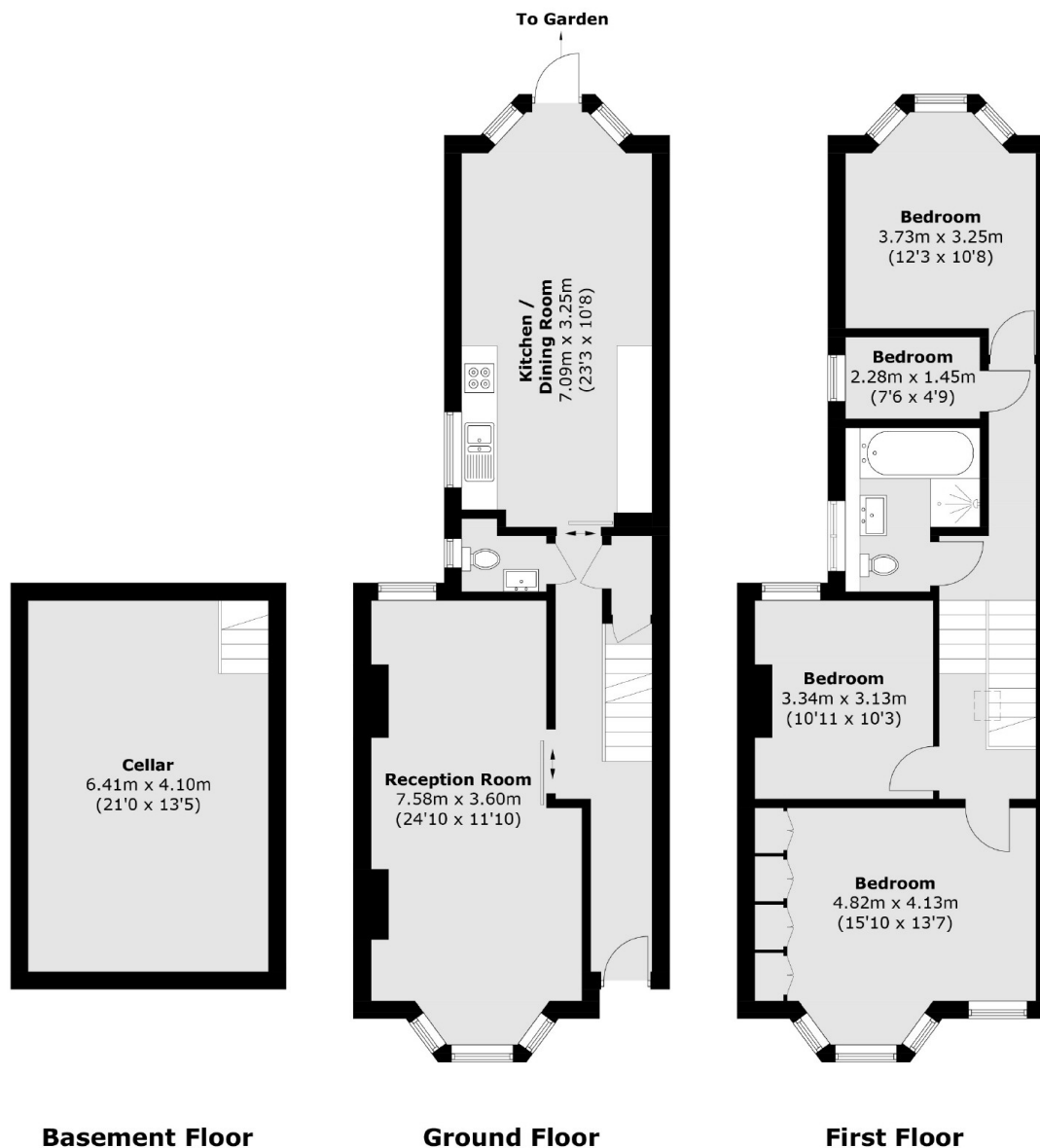

Total area (approx.): 146.1 sq. m (1,572.7 sq. ft)  
(Including Cellar)