



## Woodrush Close, SE14

£275,000

A well presented one double bedroom purpose built flat. Including a large bright living space, modern features throughout and ample storage. The property further boasts direct access to outdoor space.

Woodrush Close is located close to New Cross Gate station offering superb links in to East and Central London and is also well located for New Cross' local amenities including Sainsbury's.

### Features

- Purpose Built
- One Double Bedroom
- Large Living Space
- Modern Features
- Close To Station
- Leasehold

Woodrush Close,  
London, SE14

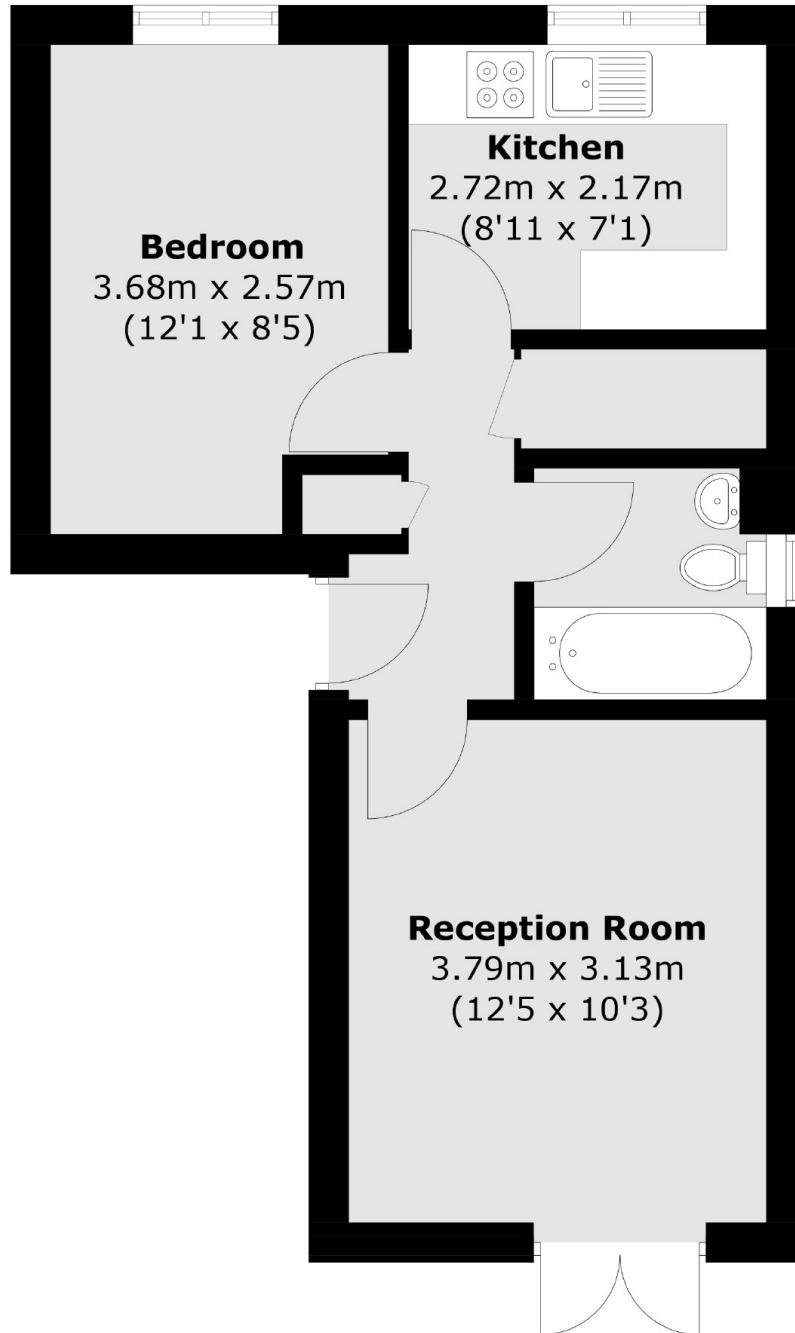

Total area (approx.): 36.7 sq. m (395.0 sq. ft)