



Lewisham Way, SE4

£685,000

This stunning 3 bedroom Victorian apartment is now available. There are 3 double bedrooms, two bathrooms and an open plan kitchen living area. The property further boasts a myriad of period features throughout and has access to a communal garden and its own private parking. There is a long lease with over 950 years remaining.

Lewisham Way is moments from St John's mainline station allowing quick and easy access into central London. Elverson Road DLR is a short walk away for direct access into Canary Wharf.

Features

- Three Double Bedrooms
- Stunning Character
- Off Street Parking
- Communal Garden
- Long Lease
- Good Condition

Lewisham Way,
London, SE4

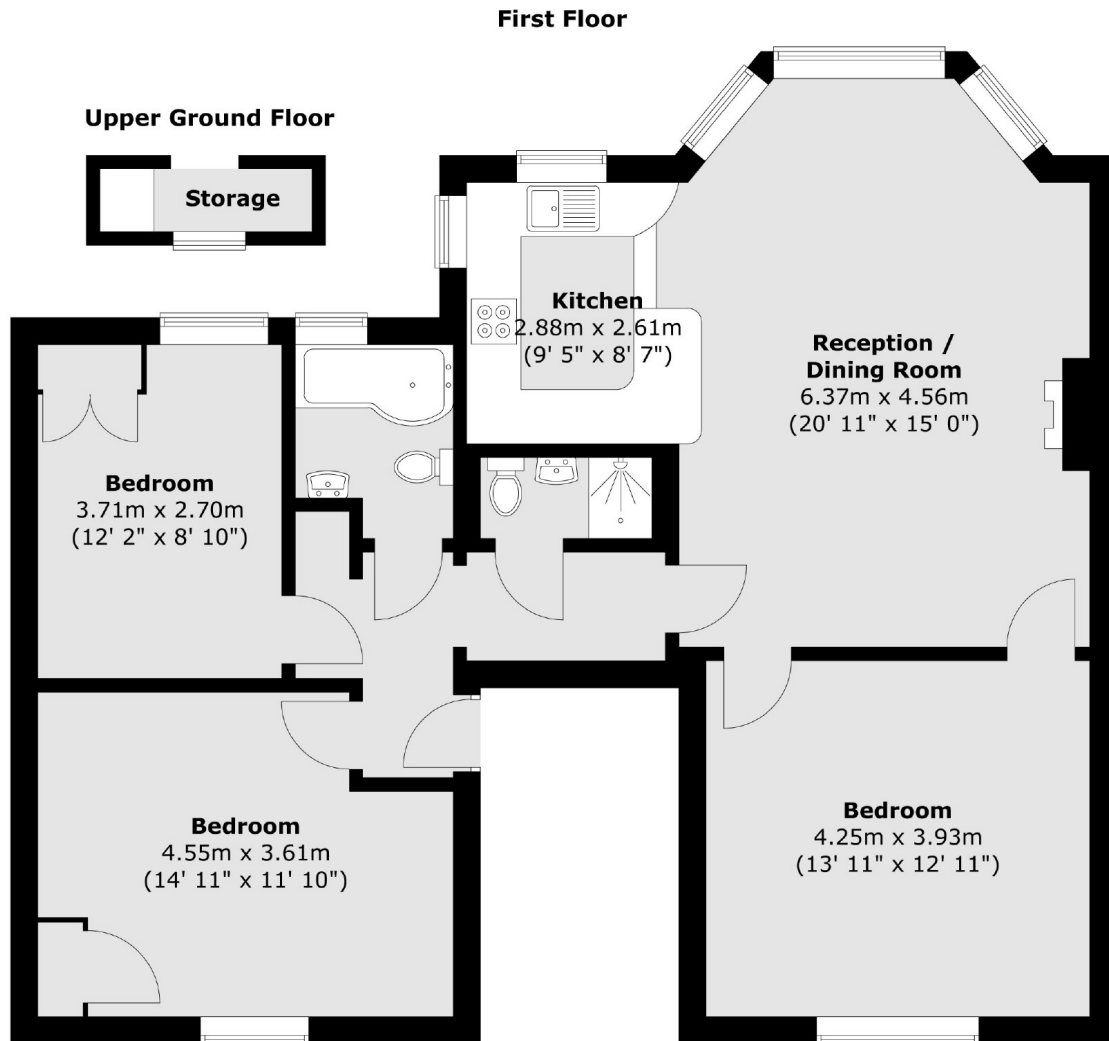

Total area (approx.) : 91.7 sq. m (987 sq. ft)
Total storage area (approx.) : 1.6 sq. m (17 sq. ft)

Dexters

New Cross
256 New Cross Road
London
SE14 5PL
Sales
020 7313 3660

Energy Rating: D. We aim to make our particulars both accurate and reliable. However they are not guaranteed; nor do they form part of an offer or contract. If you require clarification on any points then please contact us, especially if you're traveling some distance to view. Please note that appliances and heating systems have not been tested and therefore no warranties can be given as to their good working order.

 **RICS** Regulated
Estate Agent
and Letting Agent

dexters.co.uk