



Sidcup Road, SE12

£450,000

*** Offers in Excess of *** A beautifully presented three bedroom house located for easy access to the A2. The property has been refurbished throughout and comprises of two double bedrooms, one single bedroom, large living area, kitchen, bathroom with separate toilet and good size garden.

Sidcup Road is located within close proximity to Kidbrooke & Lee stations, the popular Colfe's School and the vibrant Blackheath Village.

Features

No Upward Chain
Three Bedrooms
Mid Terrace Home
Well Presented

Sidcup Road,
London, SE12

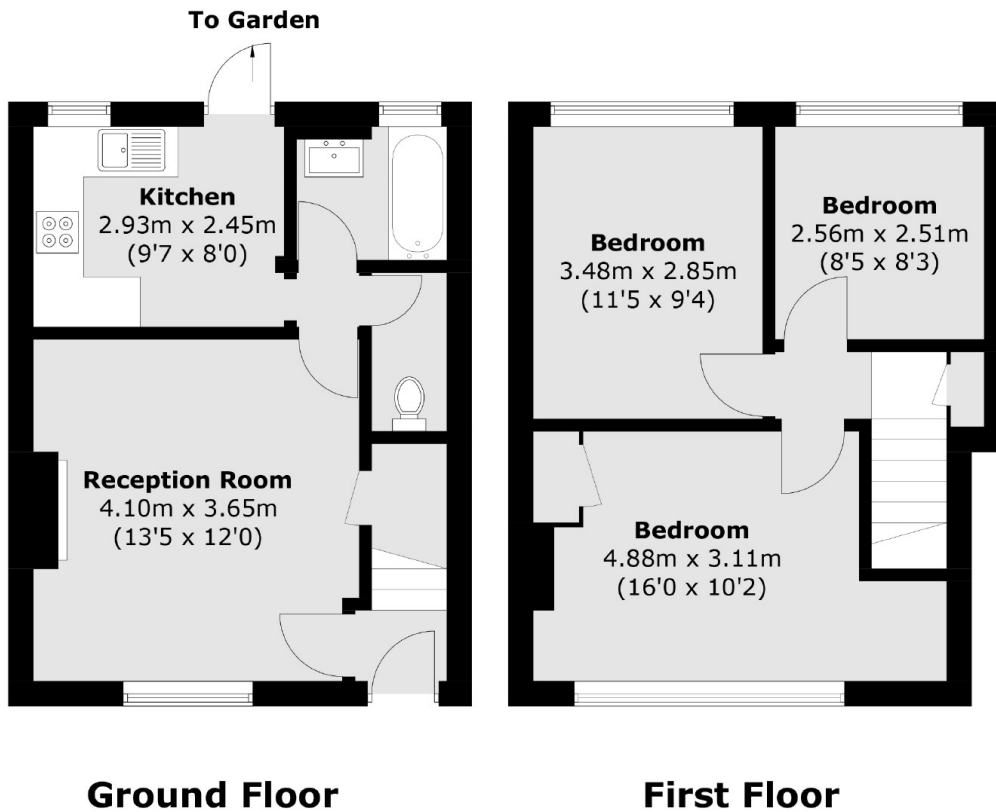

Total area (approx.): 67.7 sq. m (728.7 sq. ft)