



## Ottley Drive, SE3

### £300,000

A smart one bedroom apartment in one of the newest London neighbourhoods, Kidbrooke Village. Located in Maltby House, this stylish property is spread across 585 sq ft of internal space and comprises one double bedroom with built-in wardrobes, contemporary bathroom, open plan living and kitchen space, and private balcony. Part of the award winning Kidbrooke Village development, by premium homebuilders Berkeley Homes, this apartment is ready to view now.

Ideally located in one of London's most popular locations, the Royal Borough of Greenwich, Kidbrooke Village is an enviable location with the green spaces of Blackheath and Greenwich close by, along with their many shops, bars and restaurants. Kidbrooke Station (Zone 3) is literally on your doorstep, with excellent transport links into the City. Residents of Kidbrooke Village benefit from 24hr concierge, super gym as well as various onsite shops and bars.

### Features

- Beautiful Modern Apartment
- Open Plan Kitchen/Lounge
- 24hr Concierge
- Residents' Gym
- Close To Kidbrooke Station
- Chain Free

Ottley Drive,  
London, SE3

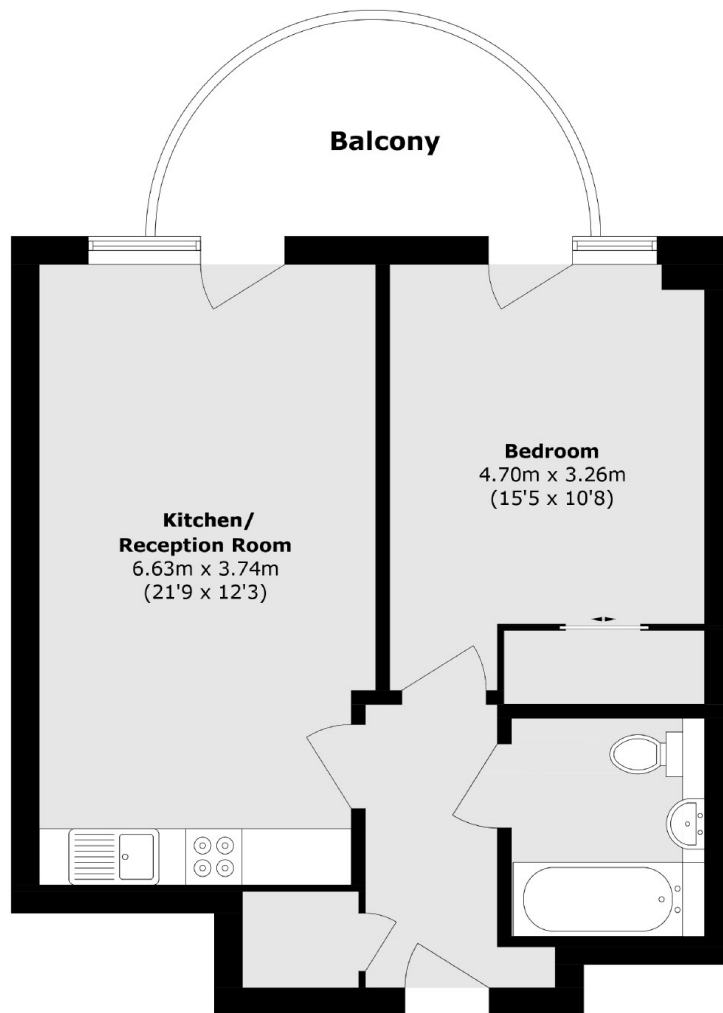

Total area (approx.): 51.6 sq. m (555.4 sq. ft)

Balcony area (approx.): 8.5 sq. m (91.4 sq. ft)

**Dexters**

Lee  
430-432 Lee High Road  
Lee  
London  
Sales  
020 8815 2210

Energy Rating: B. We aim to make our particulars both accurate and reliable. However they are not guaranteed; nor do they form part of an offer or contract. If you require clarification on any points then please contact us, especially if you're traveling some distance to view. Please note that appliances and heating systems have not been tested and therefore no warranties can be given as to their good working order.

 **RICS** | Regulated  
Estate Agent  
and Letting Agent

[dexters.co.uk](https://www.dexters.co.uk)