



Le May Avenue, SE12

£240,000

This charming one-bedroom apartment offers a perfect blend of comfort, style, and convenience, ideally situated in the sought-after residential area of Grove Park. Located on a quiet, tree-lined street, the property features a bright and spacious reception room, the bedroom is a comfortable double with space for additional furnishings.

The property is located 0.2 miles from Grove park Station which quickly gets you into Central London, the property is also walking distance to all amenities in Grove Park. Holm Court also has the added benefit of being within close proximity to local amenities in Lee.

Features

- Fitted Kitchen With Ample Storage
- Close Proximity To Grove Park Station
- Convenient Location
- Double Bedroom
- Walking Distance To Local Amenities
- Gated Parking

Le May Avenue, London, SE12

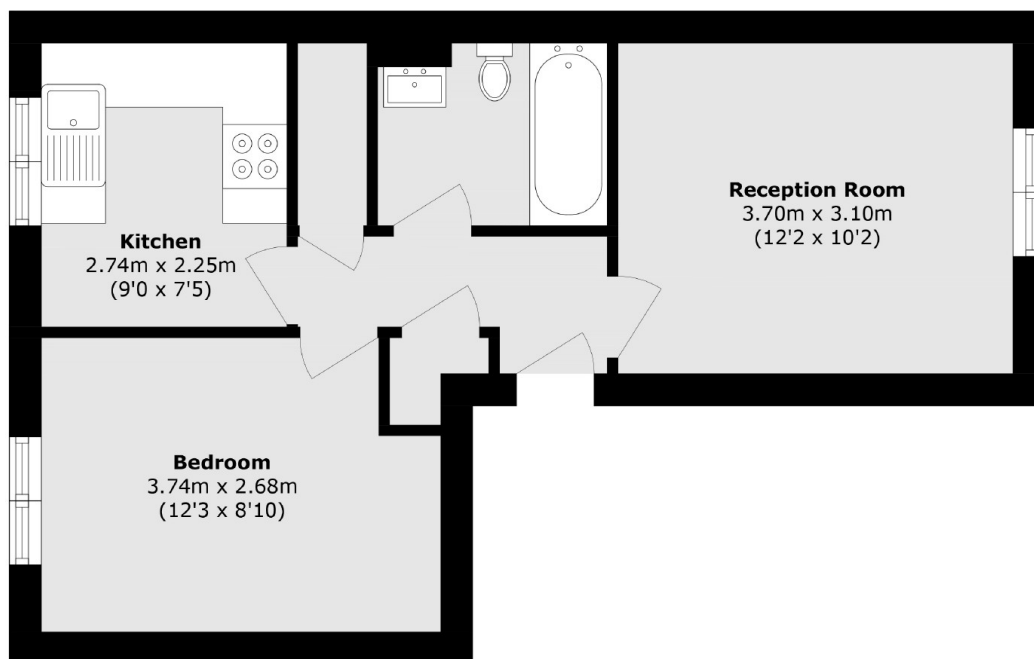

Total area (approx.): 37.2 sq. m (400.4 sq. ft)