



Balder Rise, SE12

£300,000

This charming two-bedroom apartment offers a perfect blend of comfort and convenience. The property features a spacious living area that seamlessly flows into a modern kitchen. The large windows flood the space with natural light, creating a bright and airy atmosphere. The bedrooms are generously sized, offering plenty of room for relaxation and personalisation. A standout feature is the private balcony, ideal for enjoying morning coffee or unwinding in the evening. With stylish finishes and ample storage throughout, this property offers a delightful living experience in a well-connected area.

The property is located 0.4 Miles (8 Minute walk) from Grove park Station which quickly gets you into Central London, the property is also walking distance to all amenities in Grove Park.

Features

- Two Double Bedrooms
- Double Glazed Windows
- Balcony
- Large Communal Garden
- Good Condition Throughout
- Close Proximity To Station

Balder Rise, London, SE12

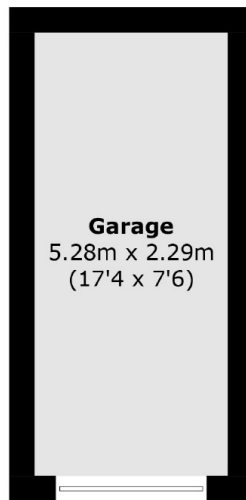

(Not Shown In Actual
Location / Orientation)

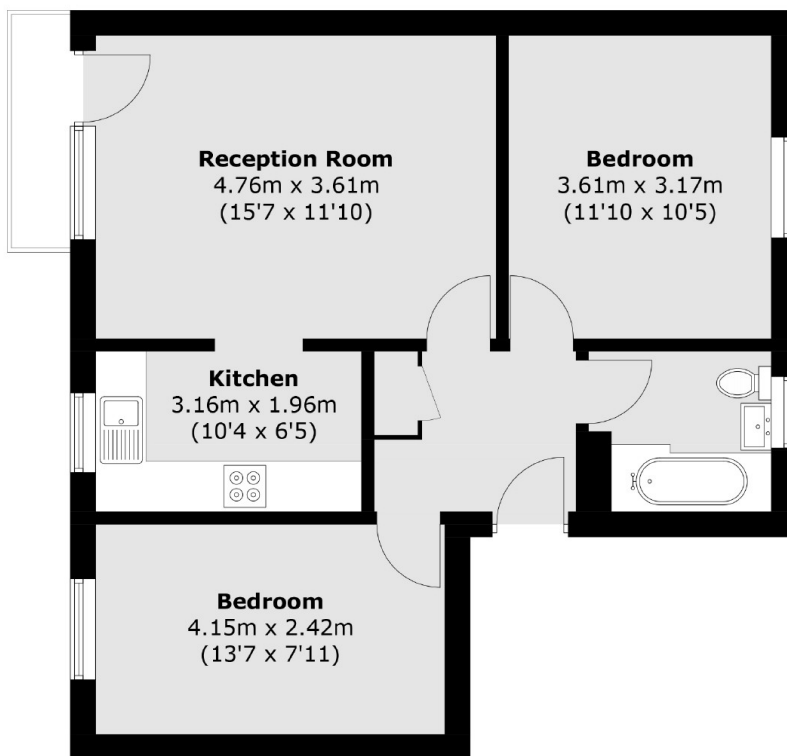

Total area (approx.): 56.8 sq. m (611.4 sq. ft)
Garage : 12.1 sq. m (130.2 sq. ft)
External area : 1.9 sq. m (20.4 sq. ft)