



## Court Mews, SE13

£600,000

This two-bedroom home is part of a contemporary gated development just a short walk from Hither Green Station. The open-plan ground floor features a kitchen with integrated appliances, a spacious living area, and access to a private courtyard garden. Upstairs, you'll find two double bedrooms and a stylish, fully tiled bathroom. Additional storage and a downstairs WC complete the home.

This area has blossomed in recent years, with a range of popular gastro pubs and restaurants opening up. It's also a hit with families, thanks to several local schools. Mountsfield Park, just a short walk away, offers a fantastic playground and various sports facilities. For

### Features

- Beautiful Contemporary Home
- Two Double Bedrooms
- Well Presented Throughout
- Gated Development
- Private Courtyard Garden
- Close To Hither Green Station



Court Mews, SE13





# Court Mews, London, SE13

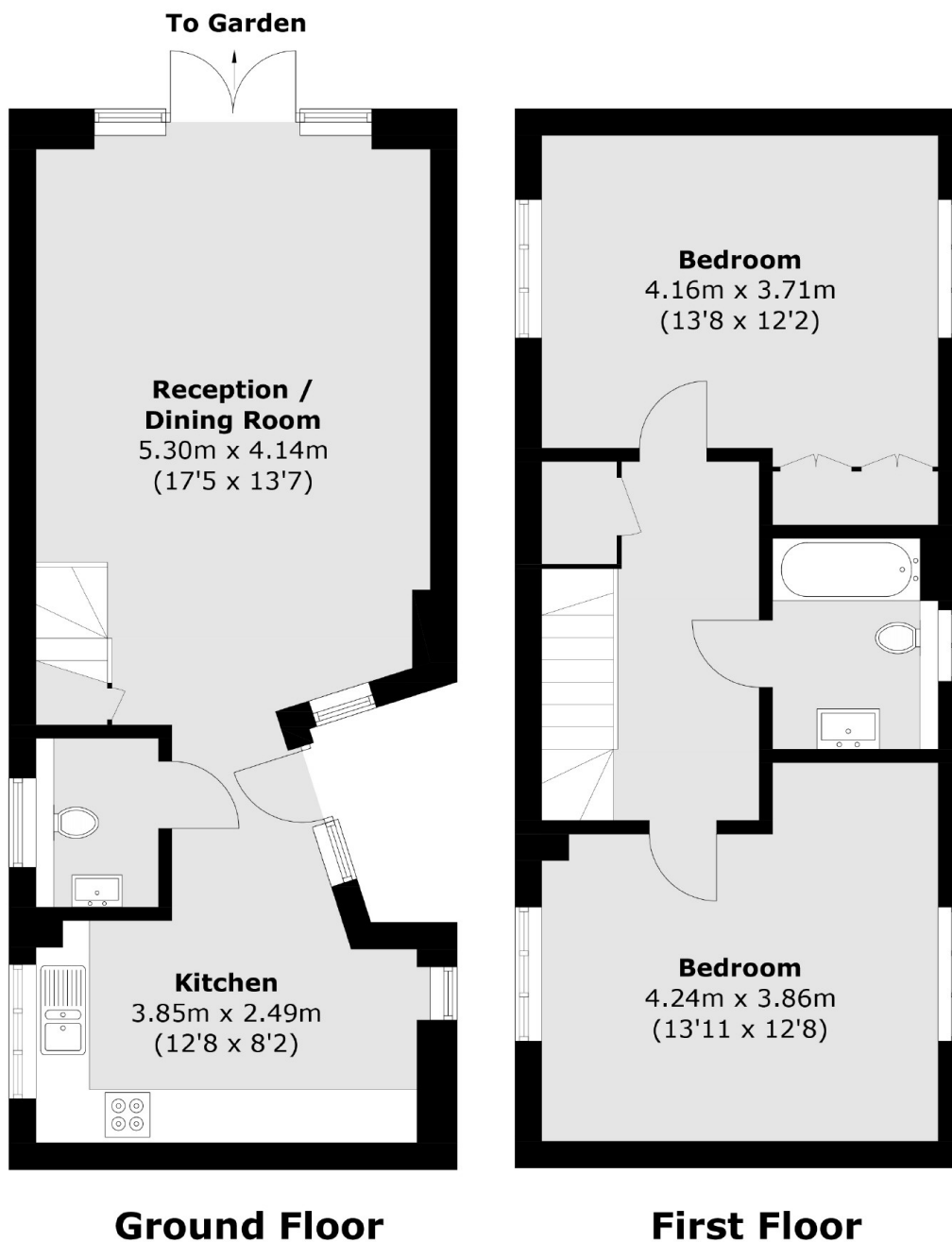

Total area (approx.): 96.1 sq. m (1,034.4 sq. ft)

## Dexters

Lee  
430-432 Lee High Road  
Lee  
London  
Sales  
020 8815 2210

Energy Rating: B. We aim to make our particulars both accurate and reliable. However they are not guaranteed; nor do they form part of an offer or contract. If you require clarification on any points then please contact us, especially if you're traveling some distance to view. Please note that appliances and heating systems have not been tested and therefore no warranties can be given as to their good working order.

 **RICS** | Regulated  
Estate Agent  
and Letting Agent

[dexters.co.uk](https://www.dexters.co.uk)