



Burnt Ash Road, SE12

£415,000

Welcome to this delightful ground-floor maisonette on Burnt Ash Road in Lee. This two-bedroom property features a generous lounge that opens into a bright dining area, ideal for hosting family and friends. The modern kitchen offers plenty of storage, offering a wonderful space for cooking and entertaining. Outside, you'll find a large enclosed rear garden, perfect for unwinding or enjoying outdoor gatherings. With potential for extension, subject to planning permission, this home offers an exciting opportunity to expand and personalize your living space.

Conveniently located, Burnt Ash Road offers easy access to local amenities, including shops, cafés, and parks. Residents benefit from excellent transport links, with nearby bus routes and both Lee & Kidbrooke train stations providing quick connections to central London and beyond.

Features

- Ground Floor Maisonette
- Two Bedrooms
- Lounge And Dining Room
- Enclosed Large Rear Garden
- Extension Potential (STPP)
- Well Presented Throughout

Burnt Ash Road,
London, SE12

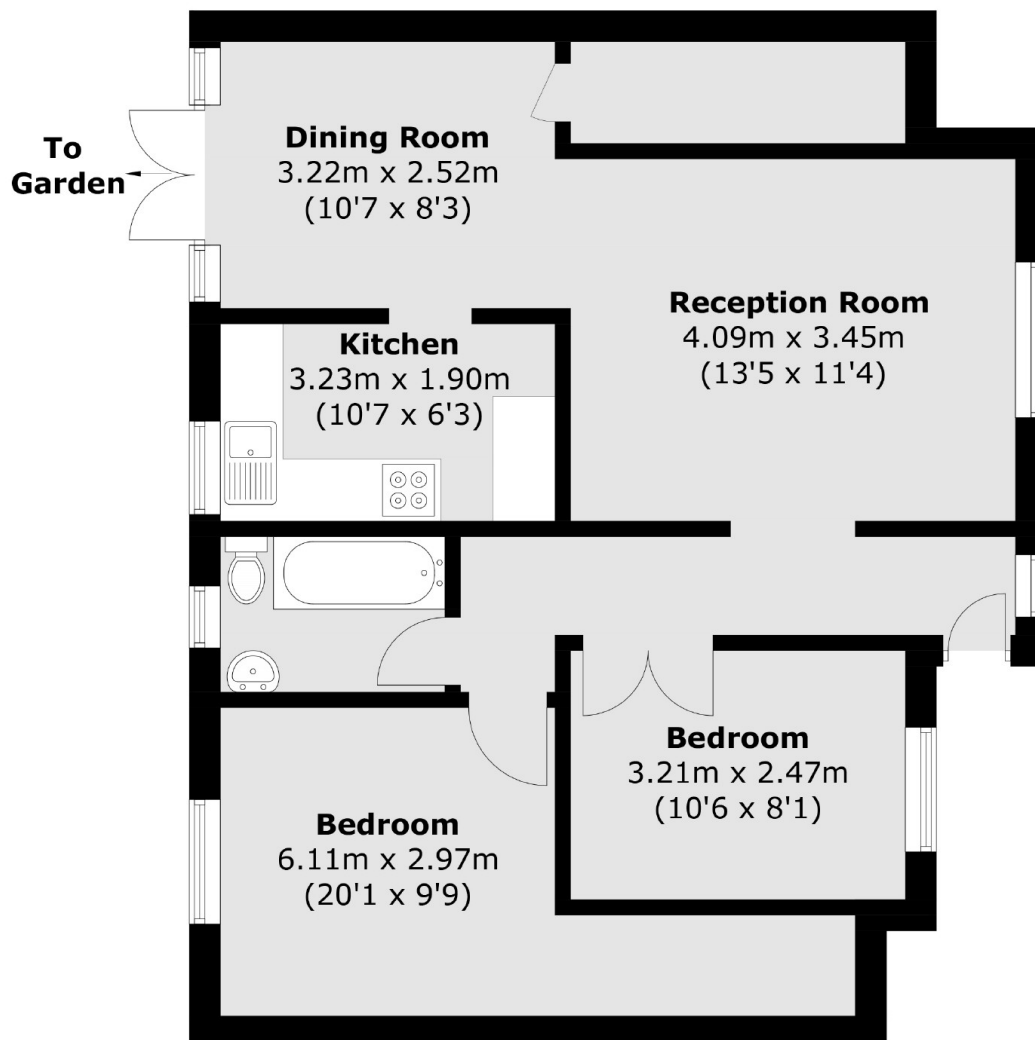

Ground Floor

Total area (approx.): 66.5 sq. m (715.8 sq. ft)

Dexters

Lee
430-432 Lee High Road
Lee
London
Sales
020 8815 2210

Energy Rating: C. We aim to make our particulars both accurate and reliable. However they are not guaranteed; nor do they form part of an offer or contract. If you require clarification on any points then please contact us, especially if you're traveling some distance to view. Please note that appliances and heating systems have not been tested and therefore no warranties can be given as to their good working order.

RICS | Regulated
Estate Agent
and Letting Agent

dexters.co.uk