



## Kidbrooke Park Road, SE3

£4,000 Per week

Situated within a quiet cul-de-sac is this beautiful five bedroom semi-detached property. Perfectly placed for a family who enjoy the urban feel of a London home.

This family house is perfectly placed close to Kidbrooke Station and within the catchment area for Thomas Tallis school.

### Features

- Cul-De-Sac
- Two Bathrooms
- Close To Kidbrooke Station
- Extended To Rear
- Large Rear Garden
- Catchment For Thomas Tallis

# Kidbrooke Park Road, London, SE3

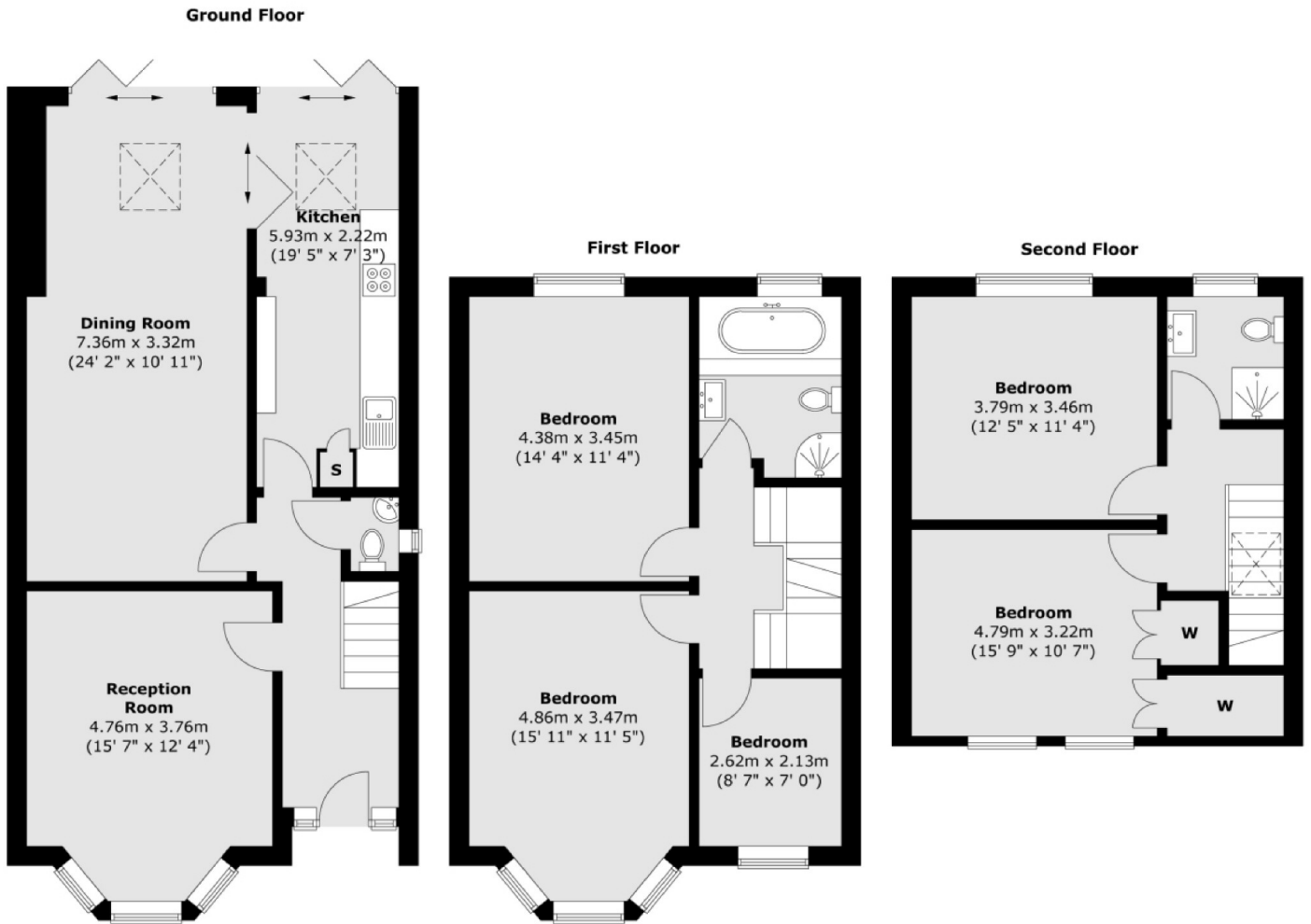

Total area (approx.) : 156 sq. m (1679 sq. ft)