



Amblecote Close, SE12

£1,750 Per calendar month

A charming two-bedroom flat close to Grove Park Station. Featuring a cozy living space, modern kitchen, and two comfortable bedrooms. Ideal for young professionals or a small family seeking a comfortable home in a desirable area

Conveniently located within easy access to the vast open spaces of Chinbrook Meadows, a scenic park with a stream, Park Cafe and playground. The property has easy access to Gyms, Supermarkets, Restaurants and Cafes. Grove Park station has frequent trains into central London.

Features

- Well presented
- Two Double Bedrooms
- Modern Kitchen
- Modern Bathroom
- Close to Grove Park Station

Amblecote Close, London, SE12

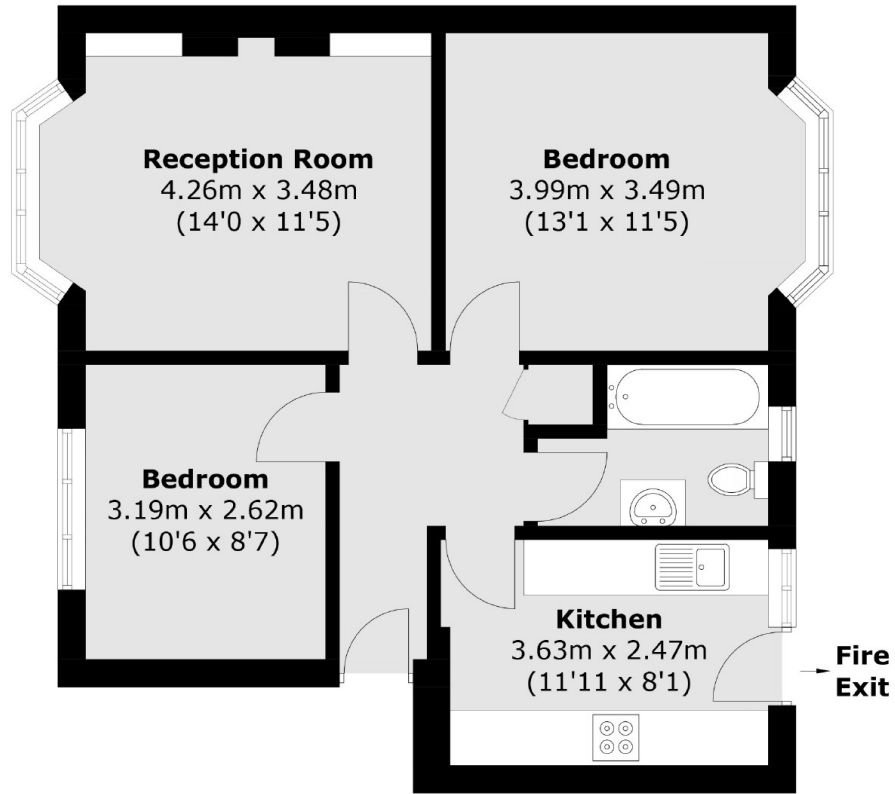

Total area (approx.): 56.1 sq. m (603.9 sq. ft)
Balcony area (approx.): 14.0 sq. m (150.7 sq. ft)