



Ravens Way, SE12

£300,000

*** Offers in Excess of *** Extremely well presented two bedroom third floor apartment on Ravens Way. This lovely property comprises of a secure well kept communal area with intercom access. Once inside the apartment you will find an entrance hallway, modern bathroom, well equipped kitchen, spacious lounge with access to the balcony, main bedroom also with access to the balcony and a second well sized bedroom.

Situated in an excellent position for transport links with good bus routes and three National Rail stations nearby (Lee, Blackheath and Kidbrooke). Conveniently located close to local shops, a Sainsbury's supermarket, yoga and gym facilities. Blackheath Village is also a short walk away with its variety of bars, cafes, restaurants and boutique shops.

Features

Third Floor Apartment
Two Double Bedrooms
Modern Kitchen & Bathroom
Spacious Lounge
Balcony
Well Presented Throughout

Ravens Way,
London, SE12

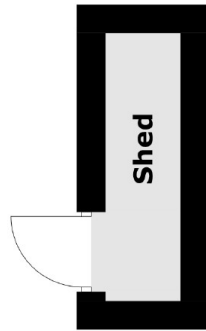

(Not Shown In Actual
Location / Orientation)

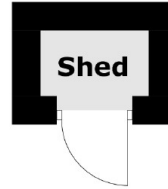

(Not Shown In Actual
Location / Orientation)

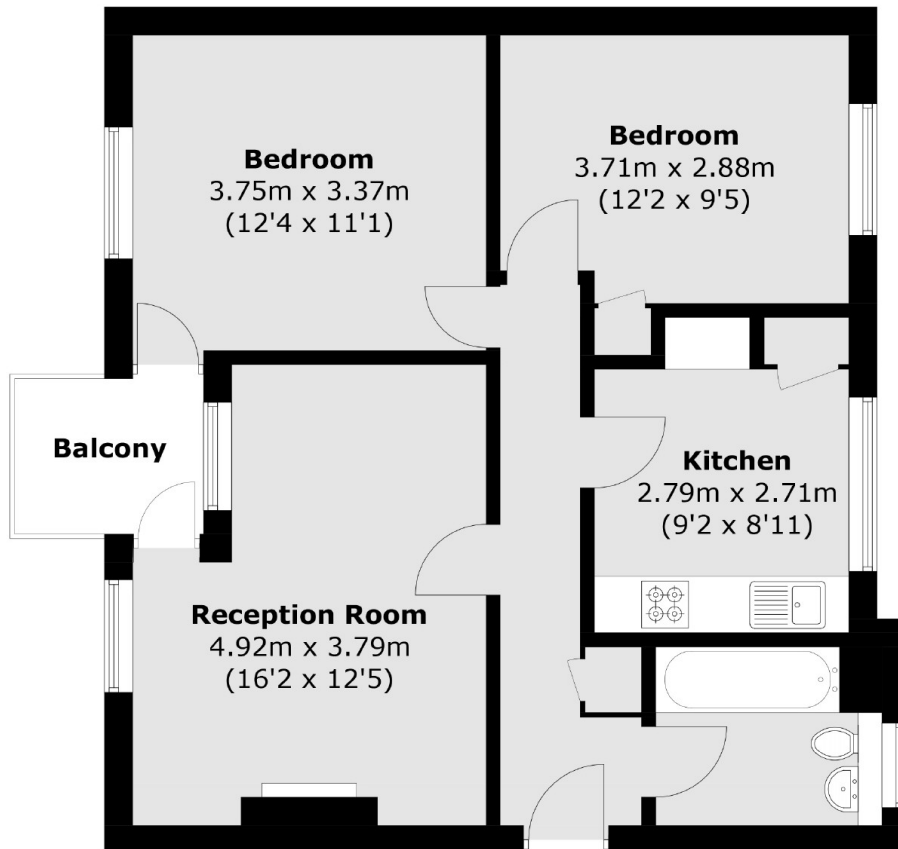

Total area (approx.): 62.5 sq. m (672.7 sq. ft)
Sheds: 3.3 sq. m (35.5 sq. ft)
Balcony: 3.3 sq. m (35.5 sq. ft)