



Winn Road, SE12

£800,000

A spacious four double bedroom family home situated on a sought after road. Benefitting from a large front drive for several cars, a new boiler recently fitted in the large garage, a fantastic sized rear garden both lawned and paved, with a structural shed and a greenhouse, fitted kitchen, and a open plan living room towards the rear. The property offers an abundance of storage both in the eaves and loft, with plenty of opportunity to extend STPP, this is a great chance to put your own stamp on a fantastic family house.

Sought after road which is located 1.0 Miles from Lee station, with direct trains to London bridge and 1.0 Mile to Grove park station with direct trains to Charing cross. Located within easy reach of number of well-regarded primary and secondary schools close by.

Features

- Detached Family Home
- Off street Parking
- Large Rear Garden
- Four Double Bedrooms
- Garage



Winn Road, SE12



Winn Road, London, SE12

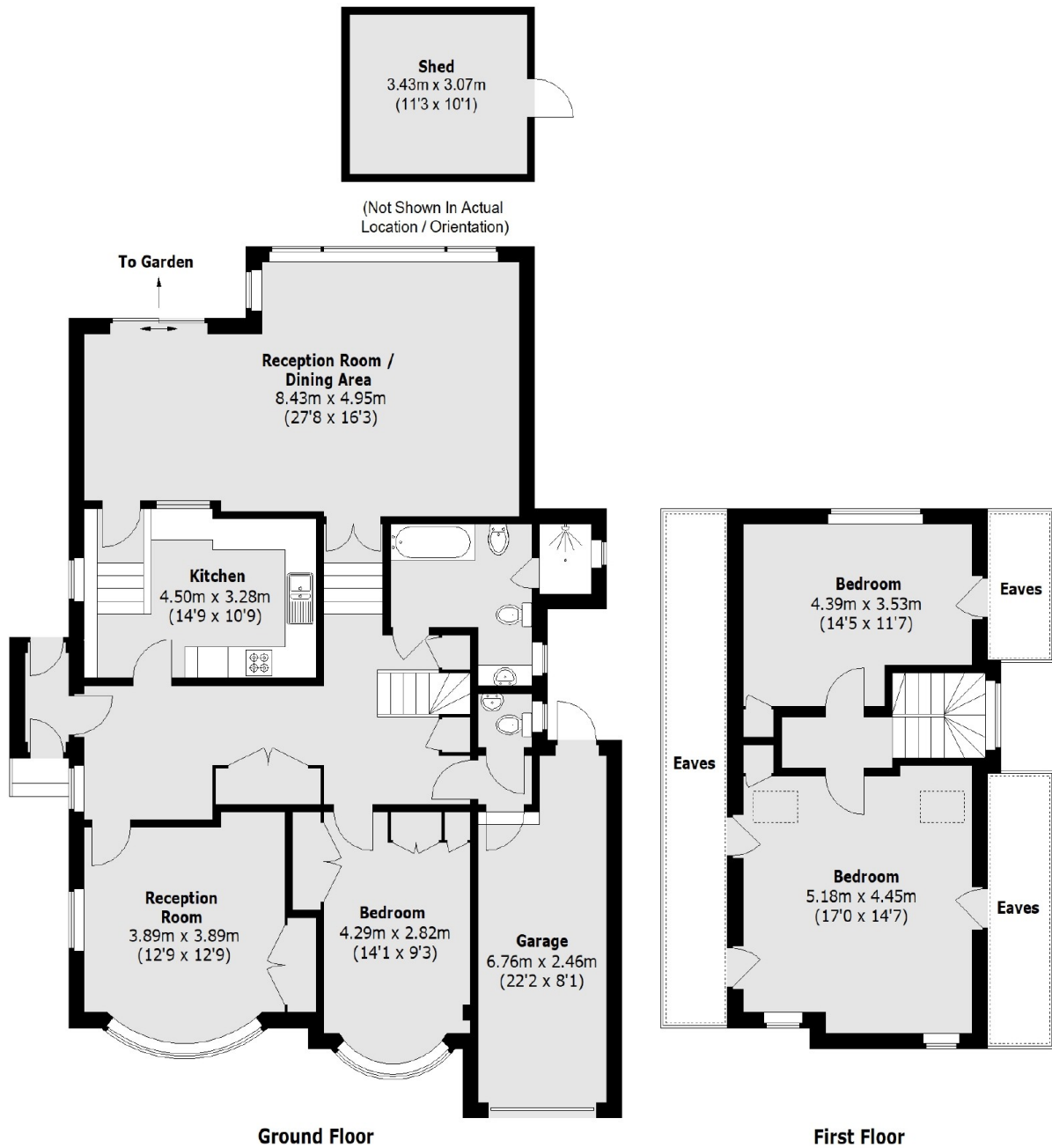

Total area (approx.)(Including Garage):184.99 sq. m (1991 Sq. ft)
(Including Garage) (Excluding Eaves)
Shed:10.69 sq. m (115 Sq. ft)