



Bramhope Lane, SE7

£145,000

Well appointed one bedroom top floor retirement flat which is offered with no chain in the popular block in Charlton. The property comes with landscaped gardens, gated parking, a communal lounge, laundry room and guest bedroom for residents. The kitchen is modern and fitted, all decor is neutral and the flat benefits from double glazing.

Situated minutes from Charlton Village for shops and amenities, bus routes to North Greenwich and the Elizabeth Line at Woolwich and close to Greenwich Park and Blackheath Royal Standard.

Features

- One Bedroom First Floor Flat
- Retirement Flat
- Beautiful Communal Garden
- Gated Parking
- Close To Shops & Bus Routes
- No Chain

Bramhope Lane, London, SE7

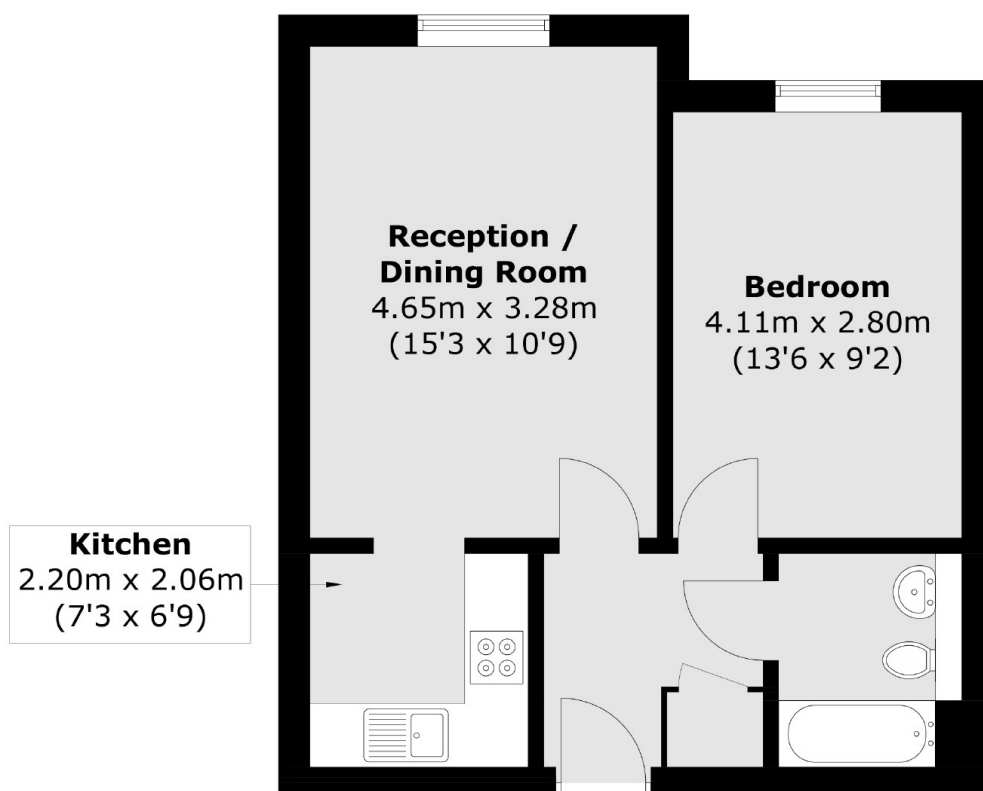

Total area (approx.): 40.4 sq. m (434.9 sq. ft)