



## Westcombe Park Road, SE3

### £275,000

A superb one bedroom ground floor retirement flat with direct access to a pretty communal garden within this popular retirement block. There is a communal reception room and laundry room for residents and comes with parking. There is also a part time warden on site and the property is offered with no chain.

In the heart of Westcombe Park, minutes from shops and amenities. Excellent location for bus routes to North Greenwich, Lewisham and Central London. Close to Greenwich park and Blackheath.

### Features

- Excellent One Bedroom Flat
- Direct Access To Garden
- Over 60's Only
- Part Time Warden
- Minutes For Buses & Shops
- No Chain

# Westcombe Park Road, London, SE3

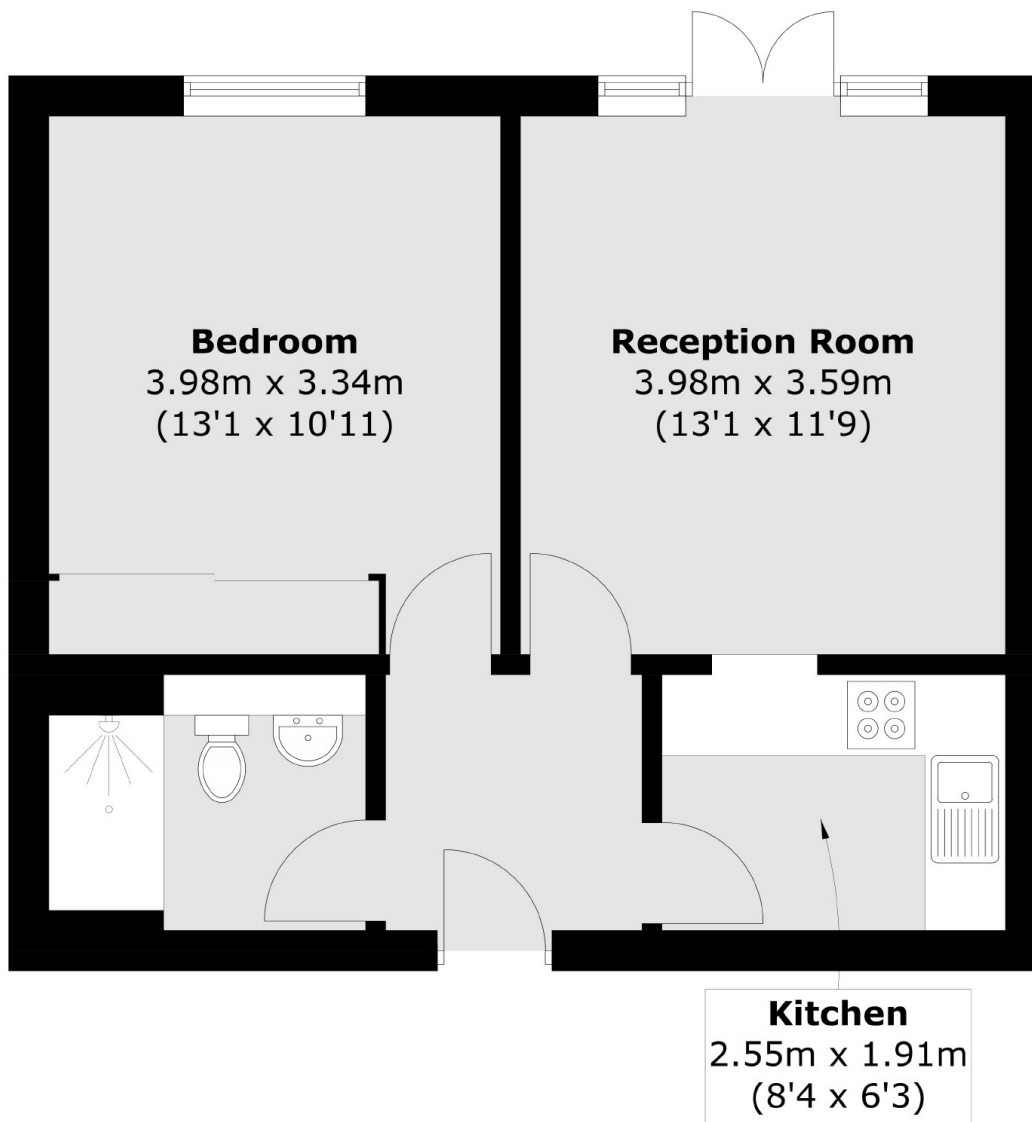

Total area (approx.): 43.2 sq. m (465.0 sq. ft)