



Elizabeth Fry Place, SE18

£500,000

Excellent three bedroom terraced house situated in a quiet cul de sac close, which offers excellent living accommodation and has potential to extend to rear (STPP).

Elizabeth Fry Place is close to the A2 and to the Elizabeth Line at Woolwich. Within easy access of Canary Wharf and from Liverpool Street. The development is positioned close to the Queen Elizabeth Hospital and within close proximity to the local supermarket. Both Blackheath and Blackheath Royal Standard are in close proximity.

Features

- Cul-De Sac Location
- Three Bedrooms
- Two Bathrooms
- South Facing Garden
- Parking
- Easy access to Elizabeth Line

Elizabeth Fry Place, London, SE18

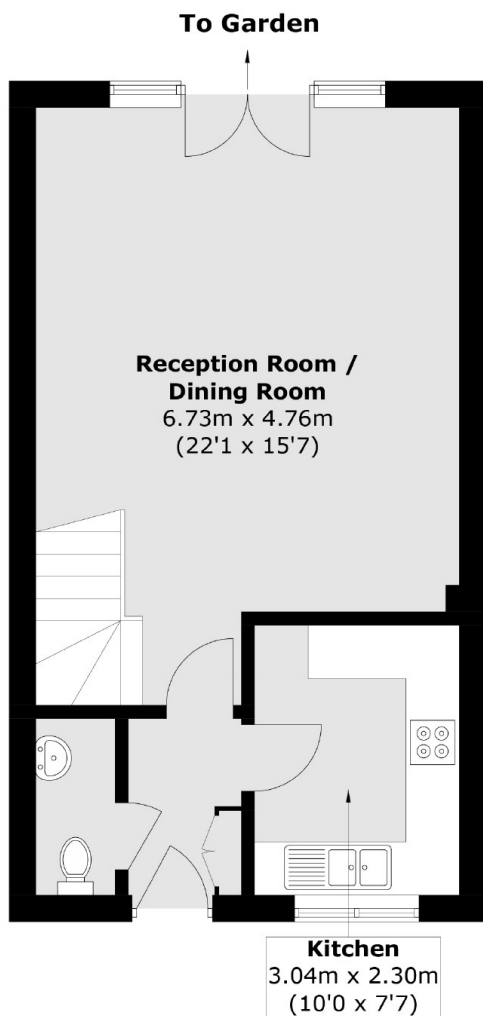

Ground Floor

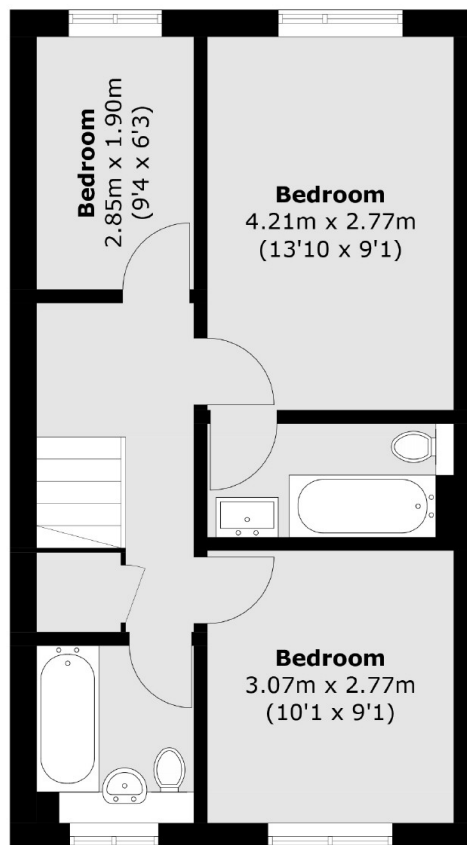

First Floor

Total area (approx.): 84.1 sq. m (905.2 sq. ft)