



## Brumwell Avenue, SE18

£535,000

Spacious and bright three double bedroom first floor purpose built apartment which offers excellent living accommodation, is well presented throughout and is offered onto the market with no chain.

The property comes with two balconies, one from the kitchen/reception room and from the main bedroom. The master bedroom has an en-suite shower room and there is a further family bathroom. Both second and third bedrooms are also doubles. Must be viewed.

Situated in a quiet residential development minutes to the centre of Woolwich for the DLR and over head station plus all the benefits of the town centre. The Elizabeth line is within close proximity and the property is 15 minutes to Canary Wharf and 25 minutes to Liverpool street door to door.

### Features

- Three Double Bedrooms
- Two Balconies
- Two Bathrooms Minutes From DLR And Station
- Large Spacious Reception Room
- No Chain

# Brumwell Avenue, London, SE18

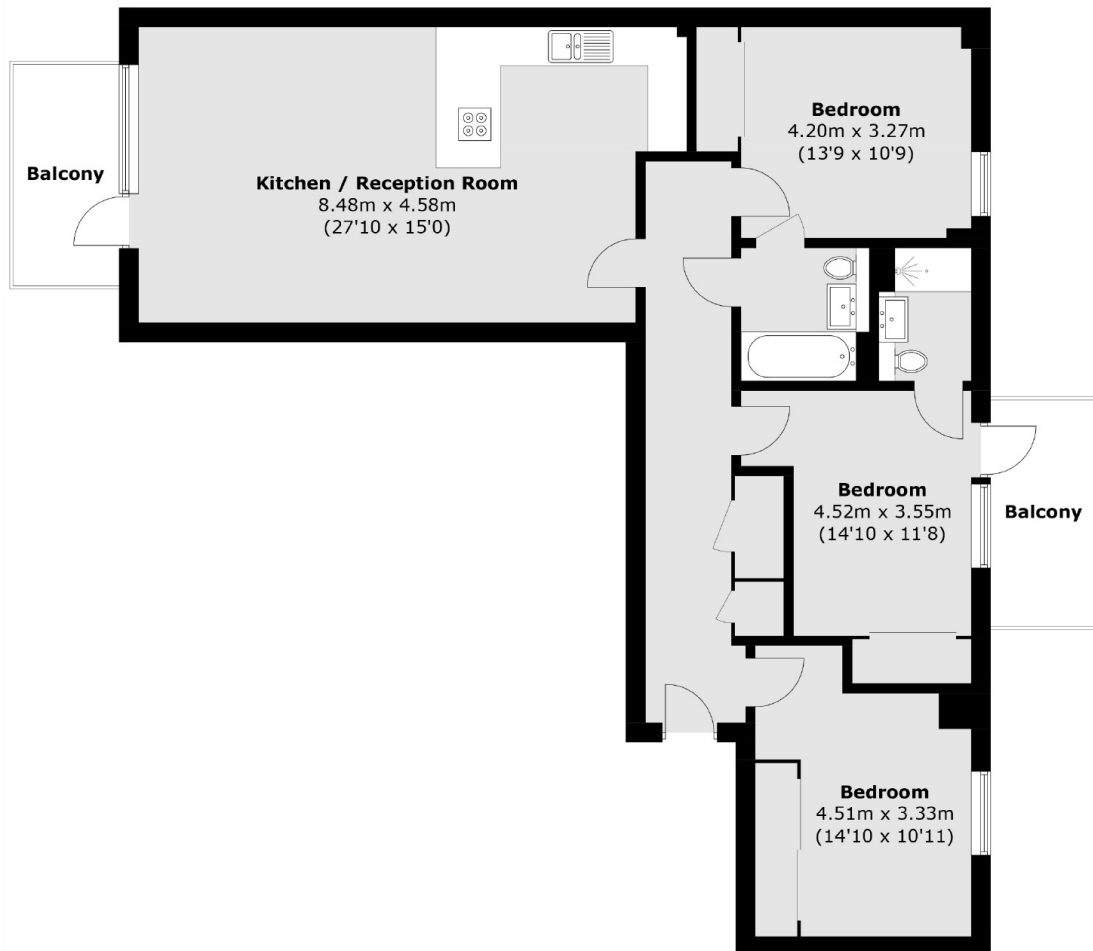

Total area (approx.): 101.7 sq. m (1,094.7 sq. ft)  
Balcony area : 11.4 sq. m (122.7 sq. ft)