



Westcombe Park Road, SE3

£325,000

A superb one bedroom ground floor retirement flat with direct access to a balcony within this popular retirement block which has beautiful communal grounds, a communal reception room and laundry room for residents and comes with parking.

Within minutes of Blackheath Royal Standard for the shops, cafés and amenities, close to bus routes for North Greenwich and Greenwich and Blackheath Village.

Features

- One Bedroom
- Direct Access To a Balcony
- Beautiful Grounds
- Warden Assisted
- Excellent For Shops
- Close To Transport

Westcombe Park Road, London, SE3

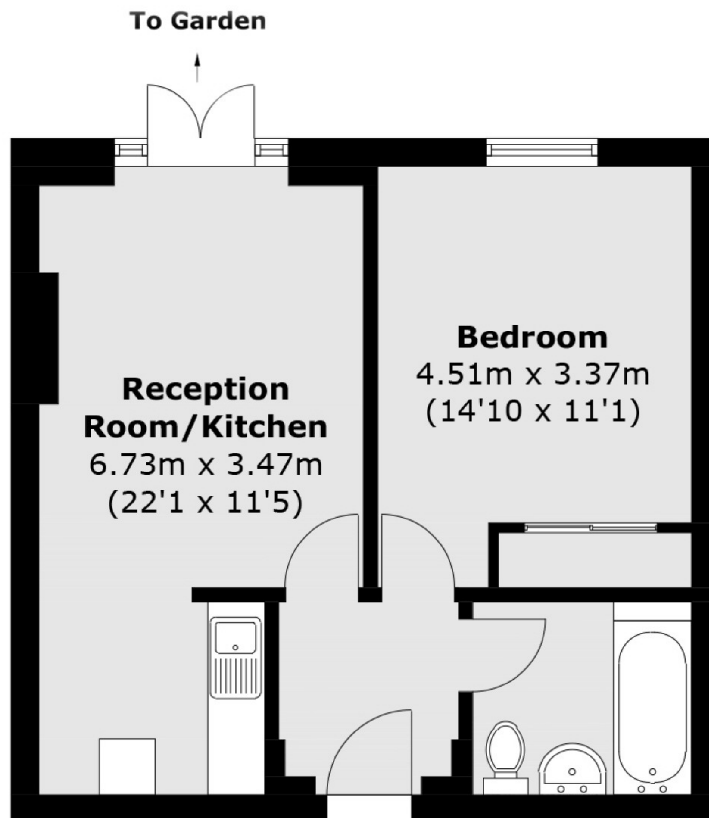

Total area (approx.): 47.0 sq. m (505.9 sq. ft)