



Little Heath, SE7

£825,000

Stunning four bedroom semi detached Victorian house which must be viewed to appreciate the space, quality of the fixture and fittings and the beautiful period features which it retains throughout.

Located minutes from Maryon Wilson Park and situated in an excellent position for short bus routes to the Elizabeth Line and Charlton Station. Charlton Village is close by for its shops and amenities and both Blackheath and Woolwich are easily accessible.

Features

- Four Bedroom Semi
- Large Kitchen/ Breakfast Room
- Beautifully Appointed
- Easy Access To Elizabeth Line
- Driveway
- Extension Potential



Little Heath, SE7

There are two reception rooms, both with high ceilings, wood floors and feature fireplaces. A large kitchen with an island unit, bespoke wall and base units and bi-folding doors onto the rear garden. There is a useful ground floor cloakroom and a basement for storage.

Upstairs are three large double bedroom's and a single room or study, as well as a family bathroom with a freestanding claw bath and a separate shower cubicle .The loft space is excellent for storage and could be converted to provide two extra bedrooms and a bathroom (STPP). The rear garden has a side access and has a patio area to the side and rear, a lawn and borders with mature shrubs and plants. Must be viewed.



Little Heath, London, SE7

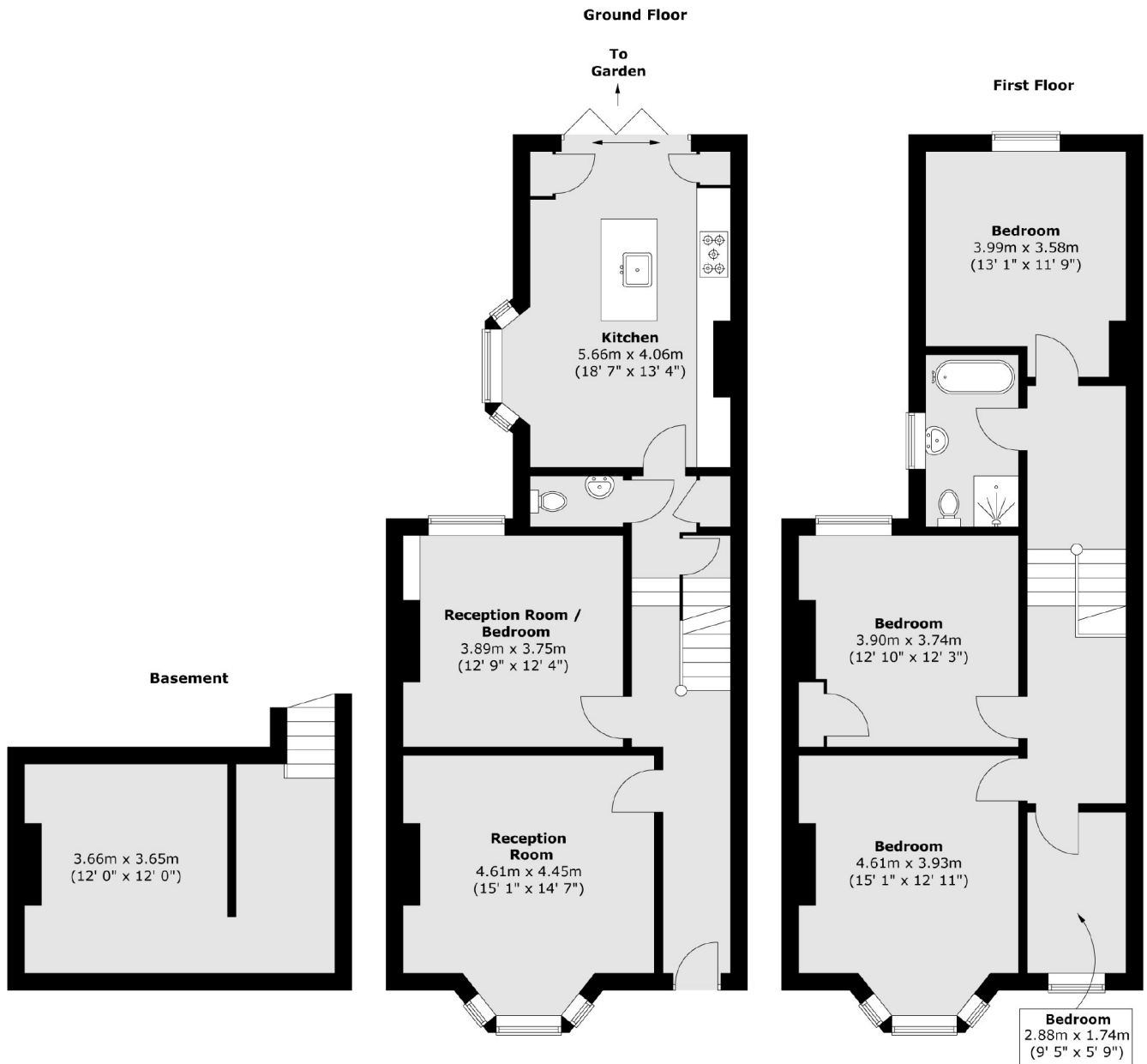

Total area (approx.) : 163.6 sq. m (1761 sq. ft)