



Thunderer Walk, SE18

£475,000

Modern two double bedroom flat with neutral decor and spacious rooms with a large West facing balcony. The property comes with a spacious entrance hall and a bright open plan reception room with a fully integrated kitchen which has access to the balcony. There are two good size bedrooms and a large family bathroom. The development offers 24 hour concierge, a gym and swimming pool. Must be viewed.

Situated on the prestigious Royal Arsenal Development, minutes from the Elizabeth Line, the River Walk and from all the new amenities that this sought after development has to offer. Woolwich Arsenal DLR is within close proximity as are the shops and restaurants in Woolwich.

Features

Two Double Bedrooms
Modern And Contemporary
Large Balcony
River Location
Minutes From Elizabeth Line
Minutes To The DLR

Thunderer Walk, London, SE18

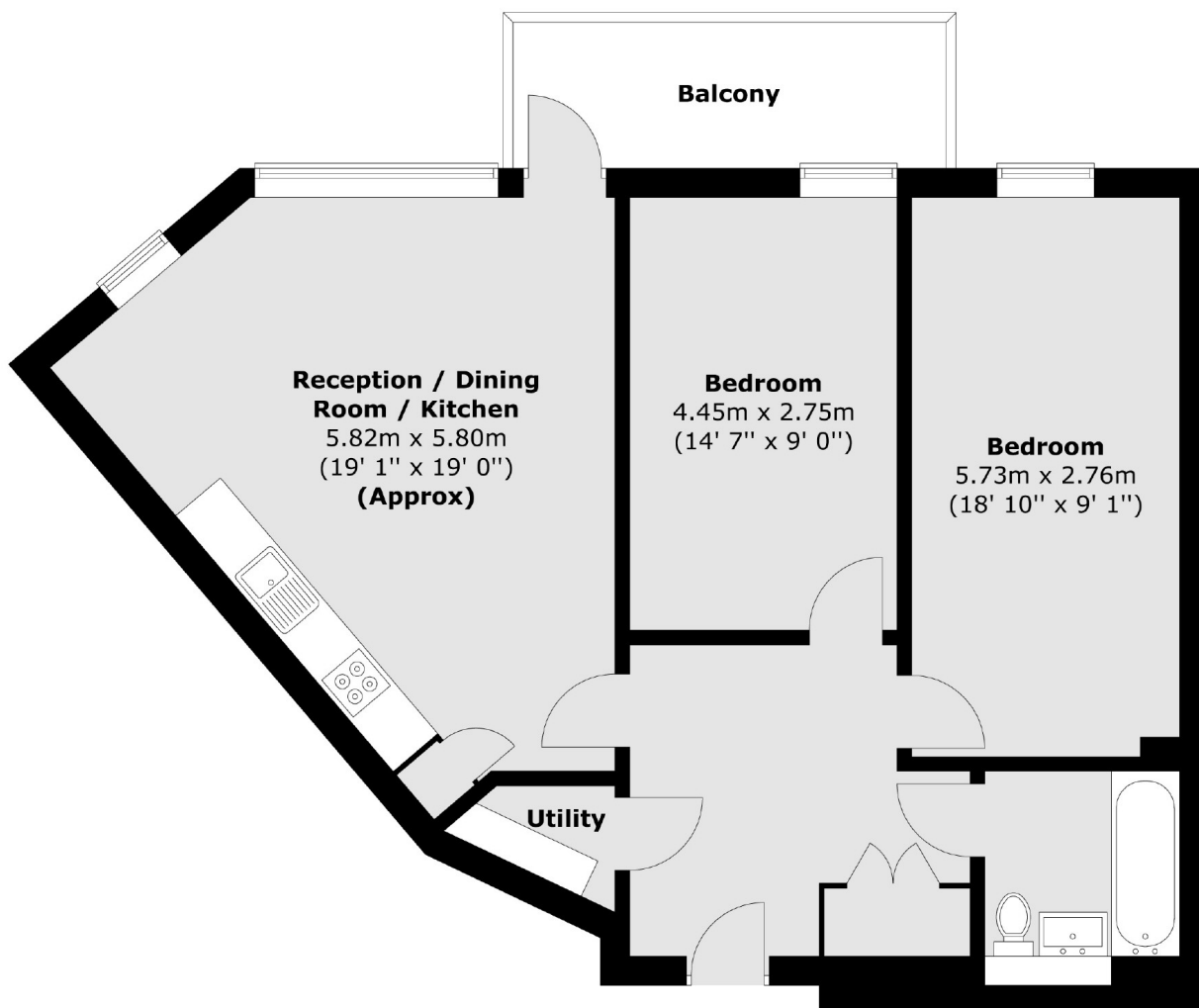

Total area (approx.) : 73.2 sq. m (788 sq. ft)
Total balcony area (approx.) : 6.7 sq. m (72 sq. ft)