



Argyll Road, SE18

£335,000

Large one bedroom apartment situated on the fourth floor of this modern block on the Riverside at Woolwich Arsenal.

Situated in the Royal Arsenal at Woolwich, minutes from the Elizabeth Line and close to the DLR at Woolwich and the Thames Clipper. The development is beautifully maintained and is located on the River. This sought after development has cafés and restaurants on site.

Features

Large One Bedroom Flat
Riverside Apartment
Minutes From The Elizabeth
Line
Immaculate Throughout
Parking space
No Chain



Argyll Road, SE18

Immaculately presented throughout, with partial river views from the reception room, a fully integrated kitchen, modern bathroom and a large bedroom again with views over the river. The property has the benefit of an underground parking space, lift access and the is offered with no chain. Must be viewed.



Argyll Road,
London, SE18

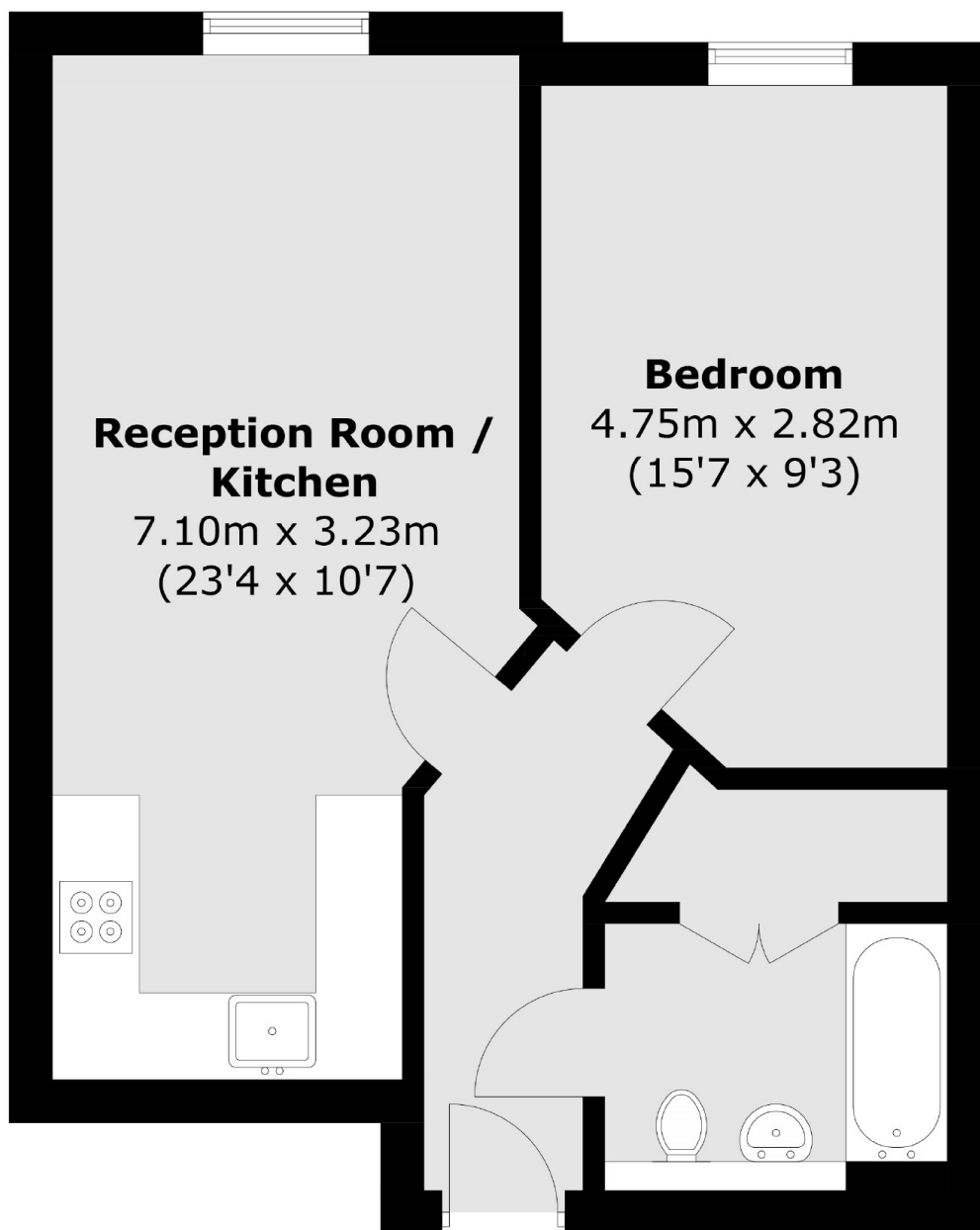

Total area (approx.): 46.2 sq. m (497.3 sq. ft)

Dexters

Blackheath
1 Stratheden Parade
London
SE3 7SX
Sales
020 8815 2200

Energy Rating: B. We aim to make our particulars both accurate and reliable. However they are not guaranteed; nor do they form part of an offer or contract. If you require clarification on any points then please contact us, especially if you're traveling some distance to view. Please note that appliances and heating systems have not been tested and therefore no warranties can be given as to their good working order.

 **RICS** | Regulated
Estate Agent
and Letting Agent

dexters.co.uk