



Woodrow, SE18

£295,000

Viewings are a must in this first floor conversion apartment which was formerly the 'Slazenger' factory. This bright and beautifully presented flat is well equipped with a fully fitted integrated kitchen which is open plan to the living area with a picture window. The bedroom is bright and airy with high ceilings and has an en-suite shower room. Ideal first time buy or investment property.

Situated in a quiet road, close to Woolwich Dockyard, the Elizabeth Line at Woolwich Arsenal and the DLR.

Features

- Stunning One Bedroom Flat
- Converted Warehouse
- Long lease
- Excellent Transport Links
- Fully Fitted Kitchen
- Close To Elizabeth Line

Woodrow, London, SE18

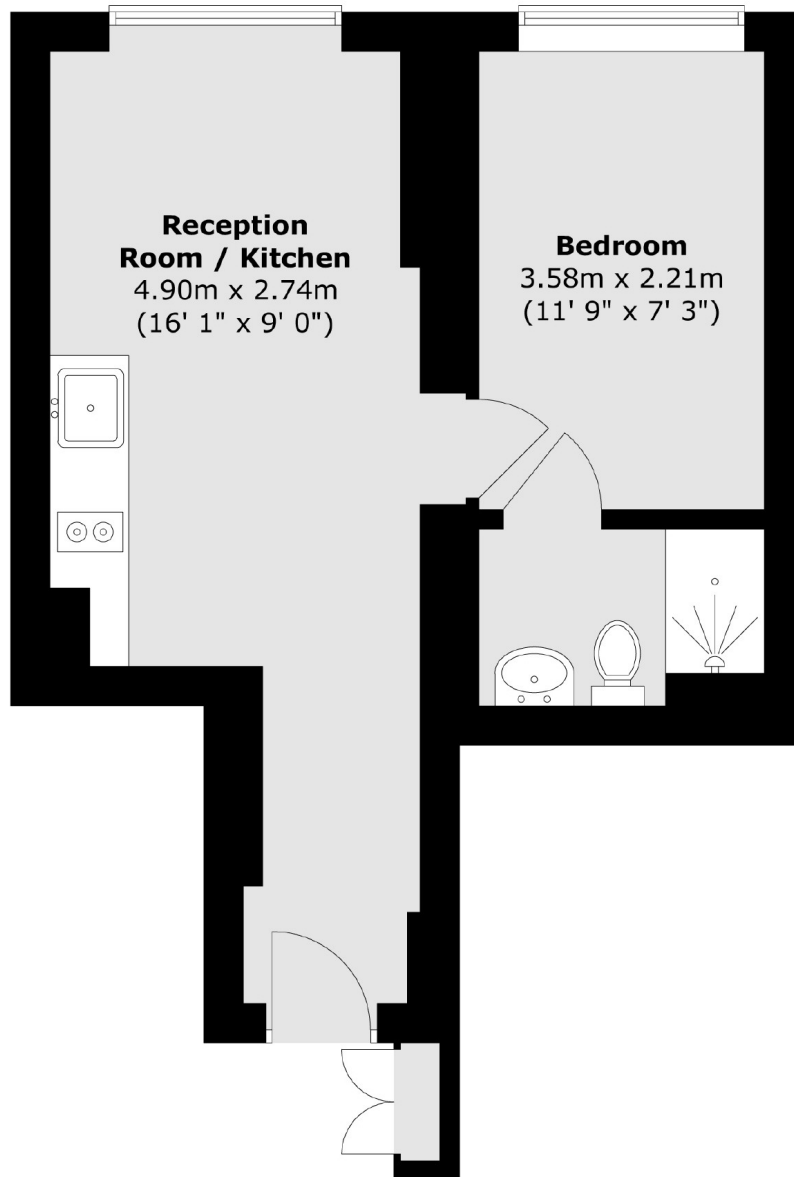

Total area (approx.) : 31.4 sq. m (338 sq. ft)