



## St. Johns Park, SE3

£375,000

Stunning one bedroom top floor conversion flat with views across tree tops and is offered with no chain. This spacious property has been refurbished throughout and should be viewed to appreciate the quality and space this flat has to offer. This property comes with a spacious reception and has bespoke built in shelving. There is a modern bathroom and a double bedroom. Outside is a large South facing garden and a parking space to front. Must be viewed.

Situated in a tree lined much sought after road in the heart of Blackheath Standard within minutes of the shops, cafés and amenities and the heath. Both Westcombe Park and Blackheath Stations are close by, and there are regular buses to North Greenwich Jubilee Line.

### Features

Stunning One Bedroom Flat  
Long Lease  
Large Communal Garden  
Close To Stations And Shops  
Off Road Parking  
No Chain

St. Johns Park,  
London, SE3

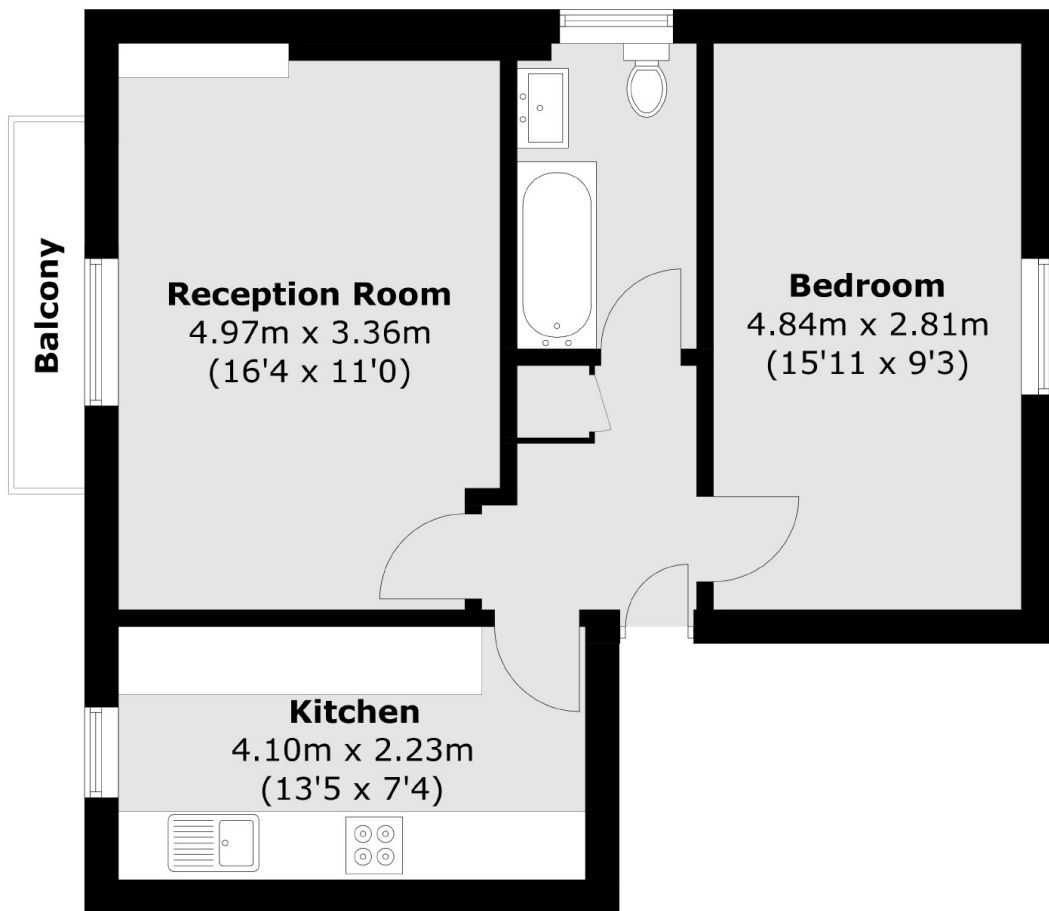

Total area (approx.): 49.5 sq. m (532.8 sq. ft)  
Balcony: 2.0 sq. m (21.5 sq. ft)