



Vanbrugh Park, SE3

£750,000

Arranged across two floors and measuring 1,396 sq ft, comes this unique split level Victorian Maisonette which has access to a large, south facing private garden, parking to the front for three cars and a large shed for storage.

Located in the heart of Blackheath Royal Standard, excellent for shops and amenities, regular buses for North Greenwich station and within a short distance of Westcombe Park Station. The property is within walking distance of sought after primary and secondary schools and of Greenwich park.

Features

Three Bedrooms
Arranged Over Two Levels
Private Garden
Parking for Three Cars
In The Heart Of Blackheath
Excellent for transport



Vanbrugh Park, SE3

This bright and spacious conversion comes with a stunning kitchen/breakfast room with cast iron stairs into the south facing private garden, There is separate reception room with high ceilings and a cast iron fireplace.

Downstairs are three bedrooms, a family bathroom and access to a conservatory/ garden room.

The private garden is beautifully planted with mature shrubs and plants and has side access. Must be viewed.



Vanbrugh Park, London, SE3

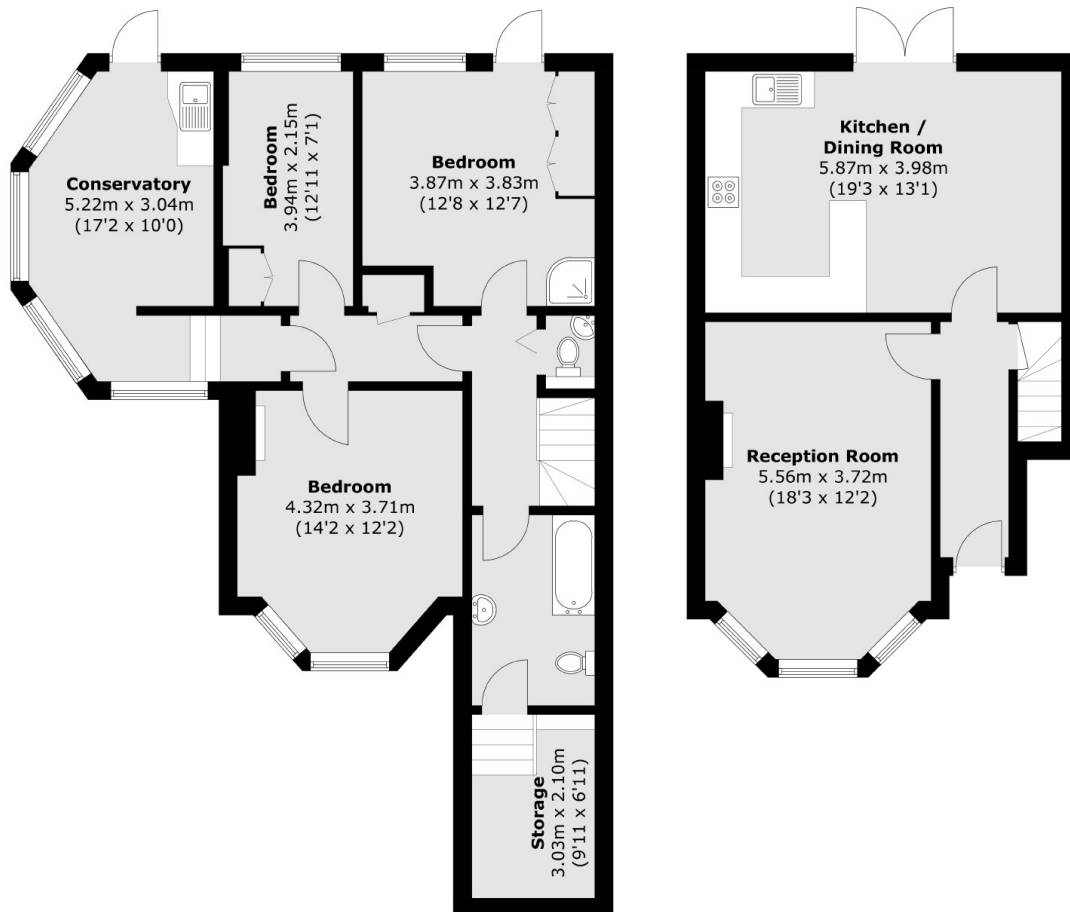

Lower Ground Floor

Ground Floor

Total area (approx.): 129.7 sq. m (1,396.1 sq. ft)